



# ASHBAUGH PARK STORMWATER INFILTRATION PROJECT

PUBLIC INFORMATION MEETING

April 16, 2026 | 5:30 - 7:30 PM



CITY OF SANTA FE  
PARKS & OPEN SPACE



# Meeting Agenda

## **Presentation (5:30 - 6:15 PM)**

- Introductions
- Project Overview
- Review Design Concepts
- Discussion and Q & A
- Next Steps

## **Breakout Groups (6:15 - 7:00 PM)**

- Share Feedback on Design Concepts
- Q & A with Project Team Members

## **Share-Out and Closing Remarks (7:00 - 7:30 PM)**



## Surrounding Area



Looking East toward Santa Fe Indian School



Looking West along the Acequia Madre

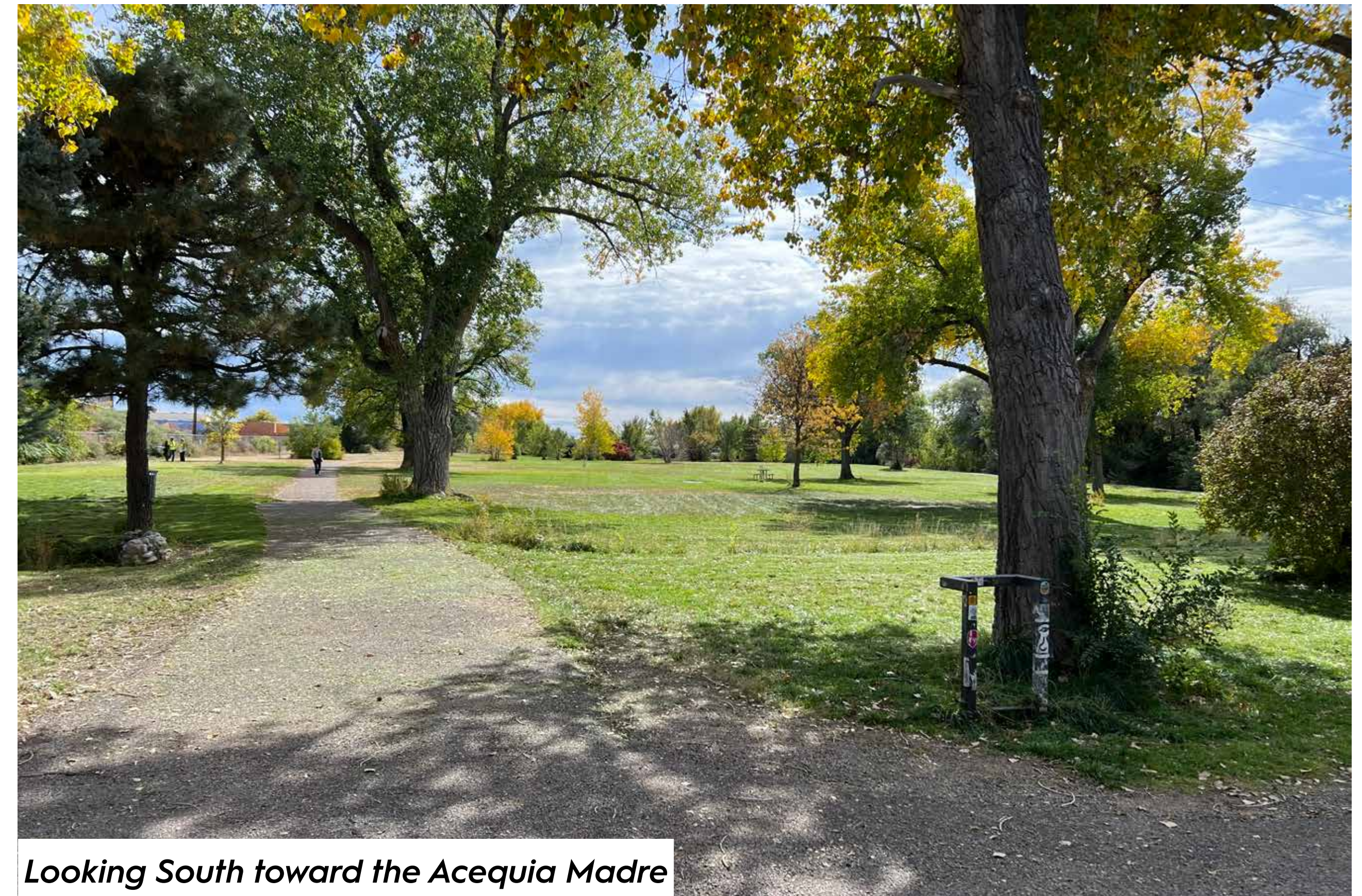

Looking South toward the Acequia Madre



Looking South along Ashbaugh Channel



Acequia Madre Culvert



Looking South toward the Basketball Court

# Project Area

# Project Background

- Bohannon Huston and Pland Collaborative completed a feasibility study for the Ashbaugh Park Stormwater Infiltration Project in January of 2023.
- The underlying purpose of the project is to divert flows from Cerrillos Road to mitigate hazardous flood conditions within the roadway and to alleviate flooding in the surrounding area.
- The design and community outreach phase of this project is funded through a Federal Emergency Management Agency (FEMA) grant program known as **Building Resilient Infrastructure and Communities (BRIC)**.
- The BRIC program funds infrastructure projects that address “the need for natural hazard risk mitigation activities that promote resilience with respect to natural hazards.”
- Funding for the construction phase of the project has not yet been secured.



*The entrance to Ashbaugh Channel north of Cerrillos Road.*

# Project Goals

- **Reduce flooding issues** along Cerrillos Road and in the surrounding neighborhood by **capturing, detaining, and infiltrating stormwater** in Ashbaugh Park. Additional benefits associated with the passive reuse of stormwater include:
  - Improved water quality and water conservation.
  - Decreased pollutant loads at the point of discharge into the Arroyo de San Antonio and Santa Fe River.
  - Additional support for locally adapted plants, which in turn provide habitat for local wildlife and contribute to greater urban biodiversity.
- **Create high-quality public open space** with new and improved amenities for the surrounding community.
- **Provide educational opportunities** related to water resource management that highlight the social, cultural, and historical importance of the Acequia Madre.

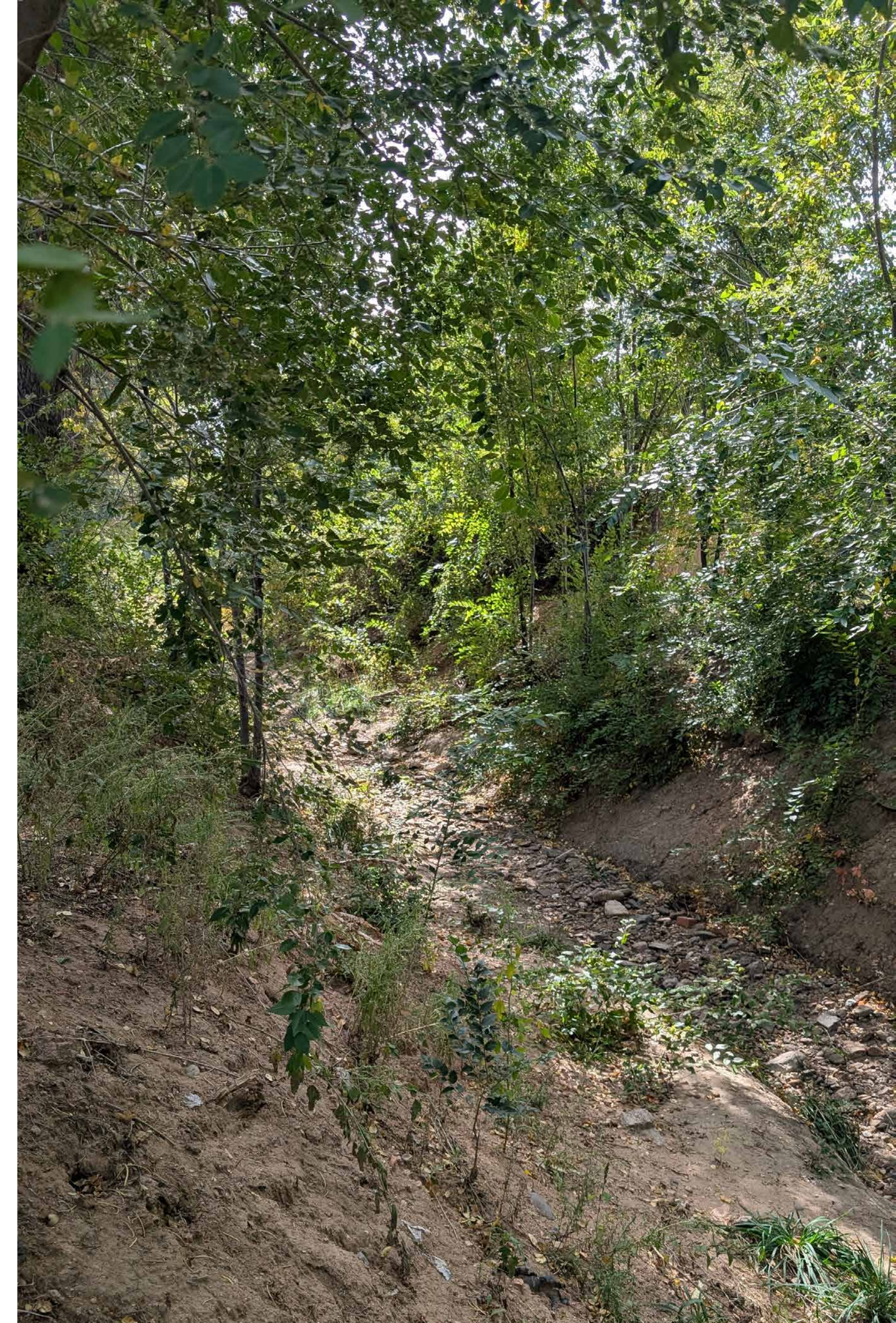

*Ashbaugh Channel, which carries runoff from Cerrillos Road, runs along the west side of Ashbaugh Park.*

# Key Stakeholders

## Santa Fe Indian School (SFIS)

The land on which Ashbaugh Park is located was once part of Santa Fe Indian School and was transferred to the City of Santa Fe in 1956 with the requirement that the land “will be used exclusively for recreational purposes.”

The City of Santa Fe has established a cooperative relationship with SFIS as part of the early stakeholder outreach for this project. The two entities will work together throughout the design and construction process to ensure that the school’s security and recreational needs are supported.

## The Acequia Madre and Its Parciantes

The Acequia Madre, which has been in use for over 500 years, runs through the project area. The new stormwater infrastructure will be physically separated from the Acequia and should not affect its flows or use.

The project team has met with the Acequia Madre mayordomo and will work with the acequia’s parciantes to share their stories in the park’s interpretive signage.



*The Acequia Madre runs through the northern section of Ashbaugh Park.*

# Key Stakeholders

## Casa Alegre Neighborhood

Ashbaugh Park is located in the historic Casa Alegre neighborhood. The project team has been in regular communication with a member of the Casa Alegre Neighborhood Association and will continue to gather input and ideas from neighbors on ways to improve the park.

## New Mexico School for the Deaf (NMSD)

The New Mexico School for the Deaf is a short drive or bike ride from Ashbaugh Park. The project team has met with NMSD staff to learn how they can better support the school's recreational and educational use of the park. The design team will use inclusive design principles to create a space that is accessible for the Deaf and Deaf Plus communities.

## Athletic Groups

The project team has met with members of the **local disc golf community** and a representative from the **youth football league** to learn how they can integrate disc golf and amenities into the redesign of the north half of the park.



*An aerial view of the Casa Alegre neighborhood.*

# Project Timeline

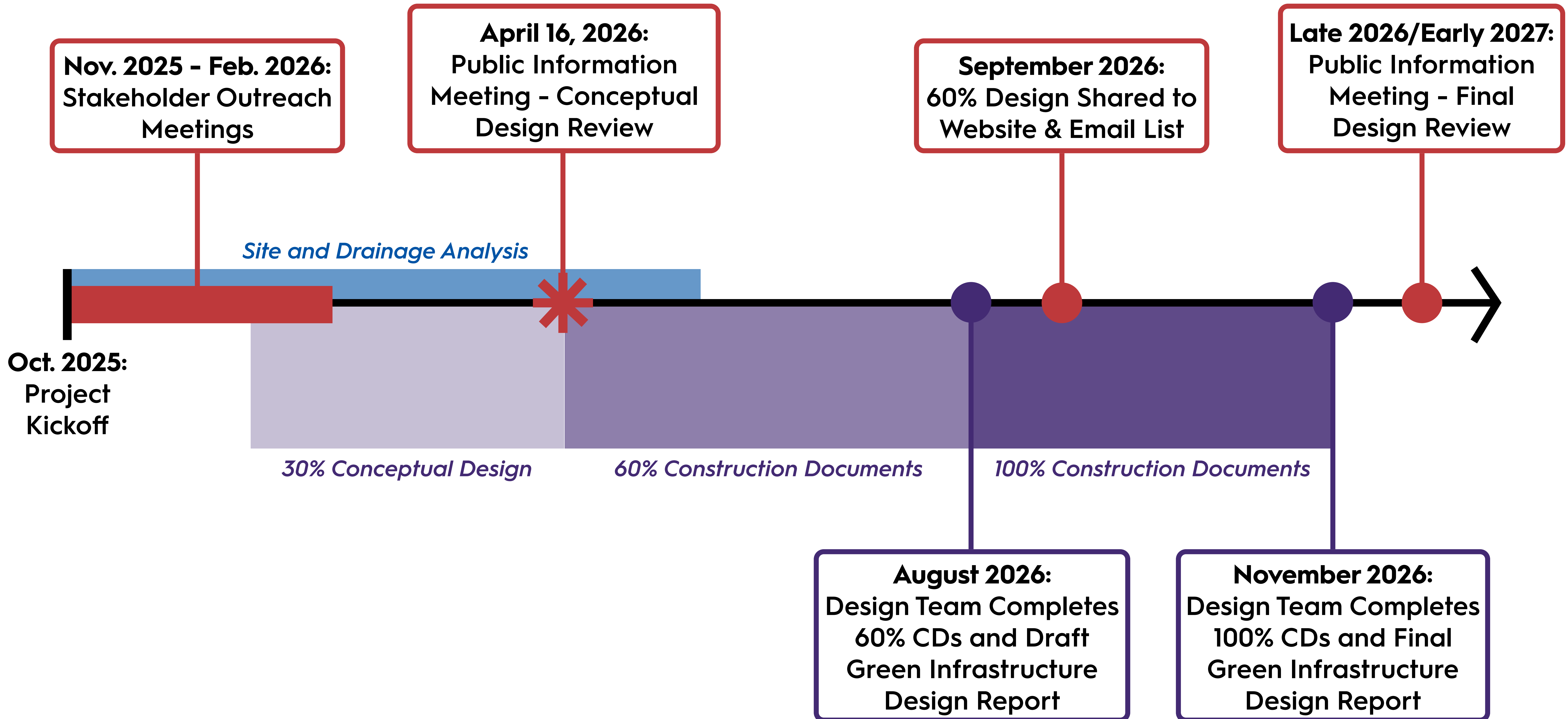

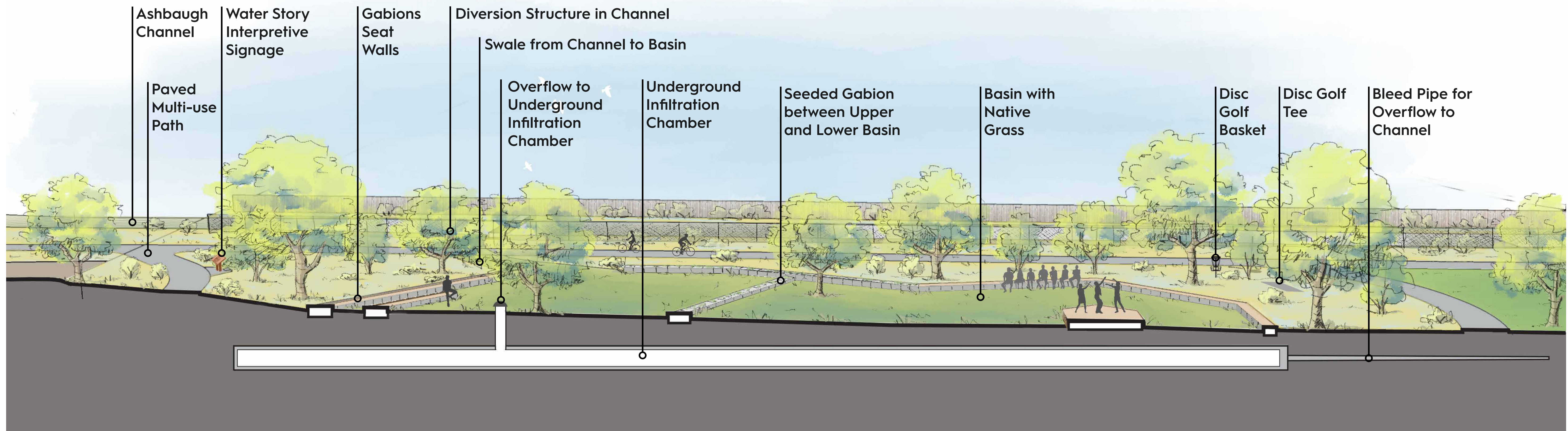

## Stormwater Infrastructure: Section A-A (Dry Condition)

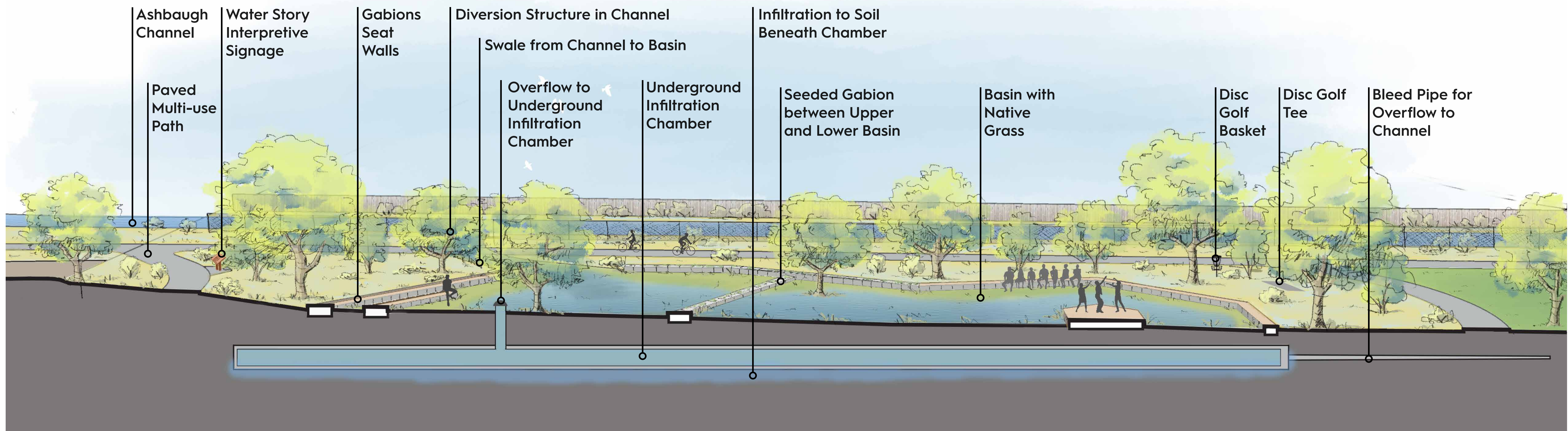

## Stormwater Infrastructure: Section A-A (Inundation Condition)

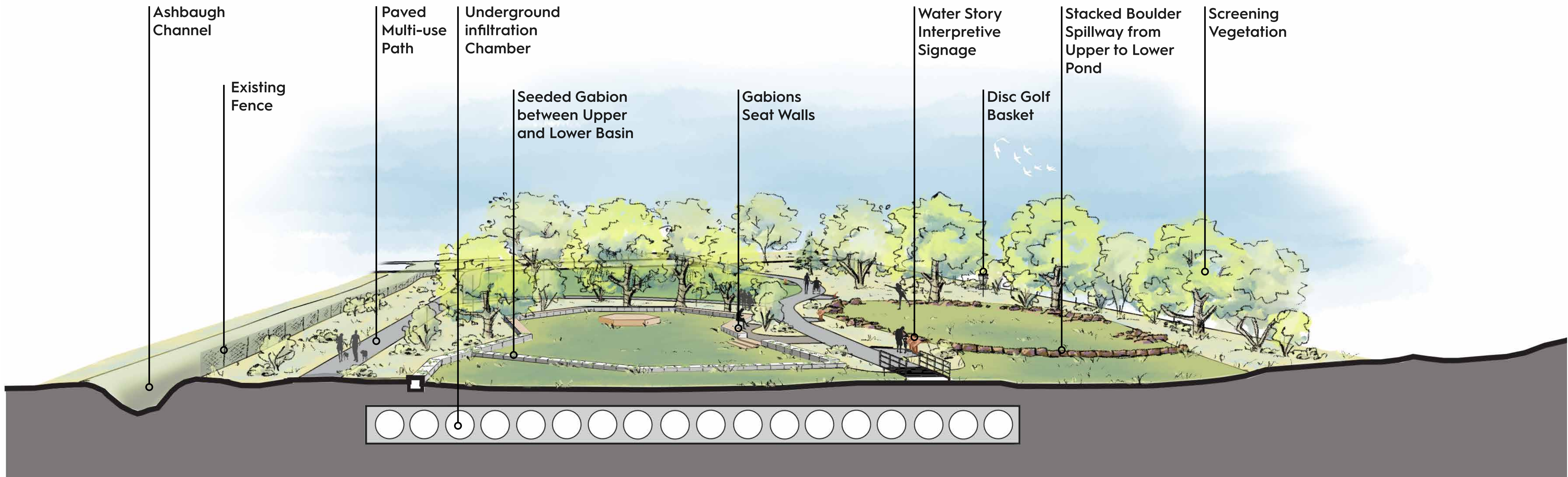

## Stormwater Infrastructure: Section B-B (Dry Condition)

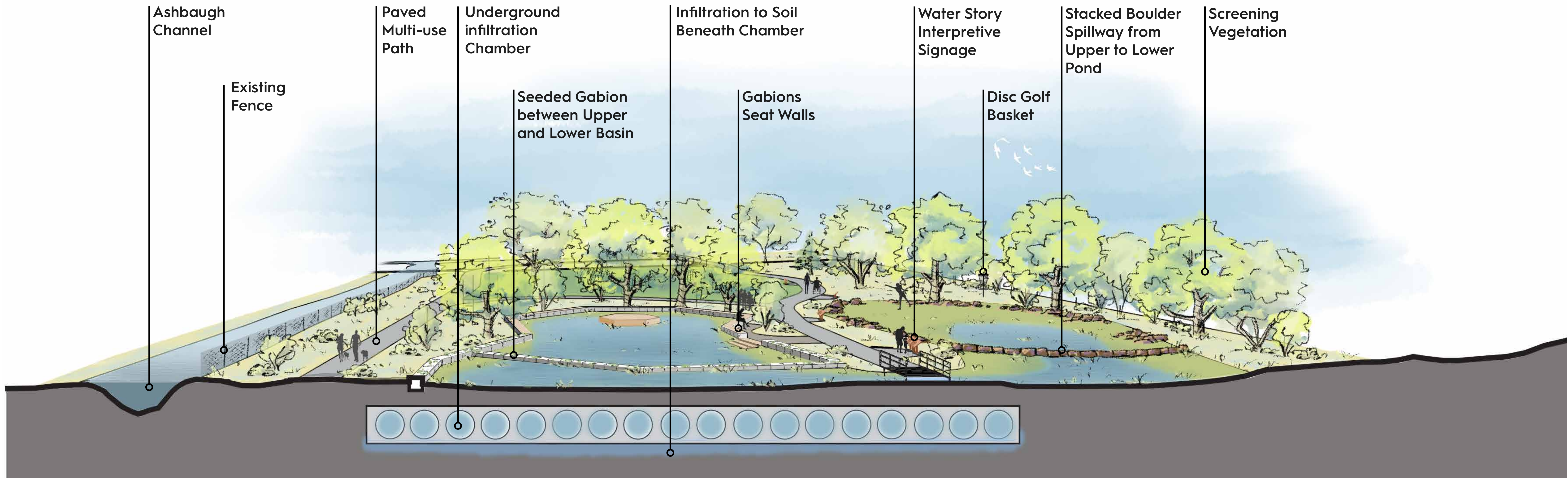

## Stormwater Infrastructure: Section B-B (Inundation Condition)



## LEGEND

- ① Shaded Gathering Area
- ② New Basketball Court
- ③ Gabion Seat Walls
- ④ Outdoor Classroom
- ⑤ New Bridge
- ⑥ Seeded Gabion Retaining Walls
- ⑦ Stormwater Harvesting Basins (Native Meadow Seeding)
- ⑧ Bioswale (Native Meadow Seeding)
- ⑨ Berm
- ⑩ Enclosed Play Area for Ages 2-5
- ⑪ Play Area for Ages 5-12
- ⑫ Seating Node
- ⑬ Nature Play Area
- Water Story Interpretive Signage
- ⚡ Disc Golf Tee
- > Stormwater Flow Line
- Existing Turf and Trees To Remain
- New Turf Grass
- Native Meadow Seeding
- New Planting Area
- New Concrete Paving
- New Crusher Fines Paving

# Concept A: Sharing Stories



**Diversion Structure**



**Bioswale w/ Native Meadow Seeding**



**Stormwater Harvesting Basin**



**Berm**



**Seeded Gabion Retaining Walls**



**Gabion Seat Walls**



**Shaded Gathering Area**



**Seating Node**



**Paved Multi-Use Path**

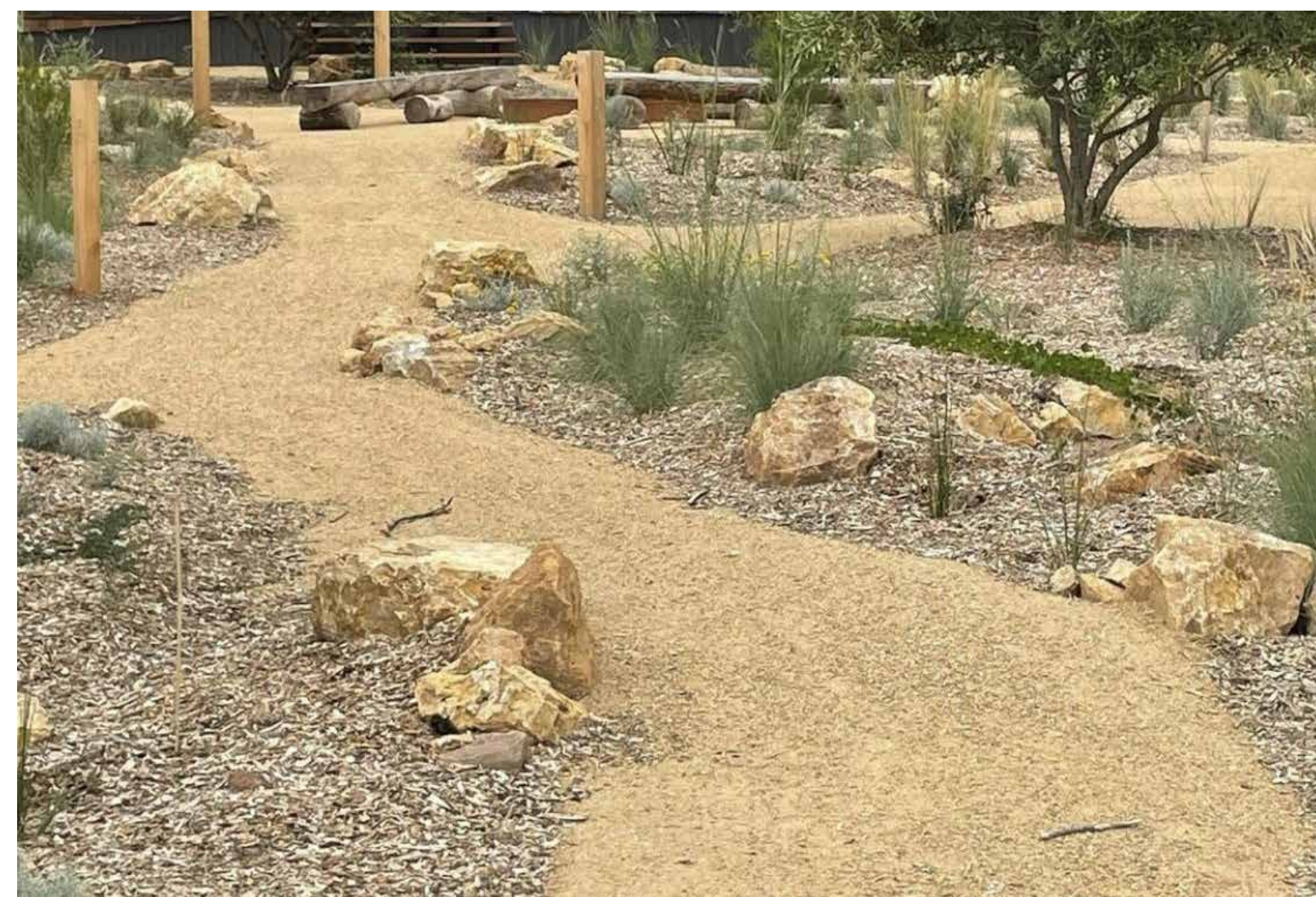

**Crusher Fines Paving**

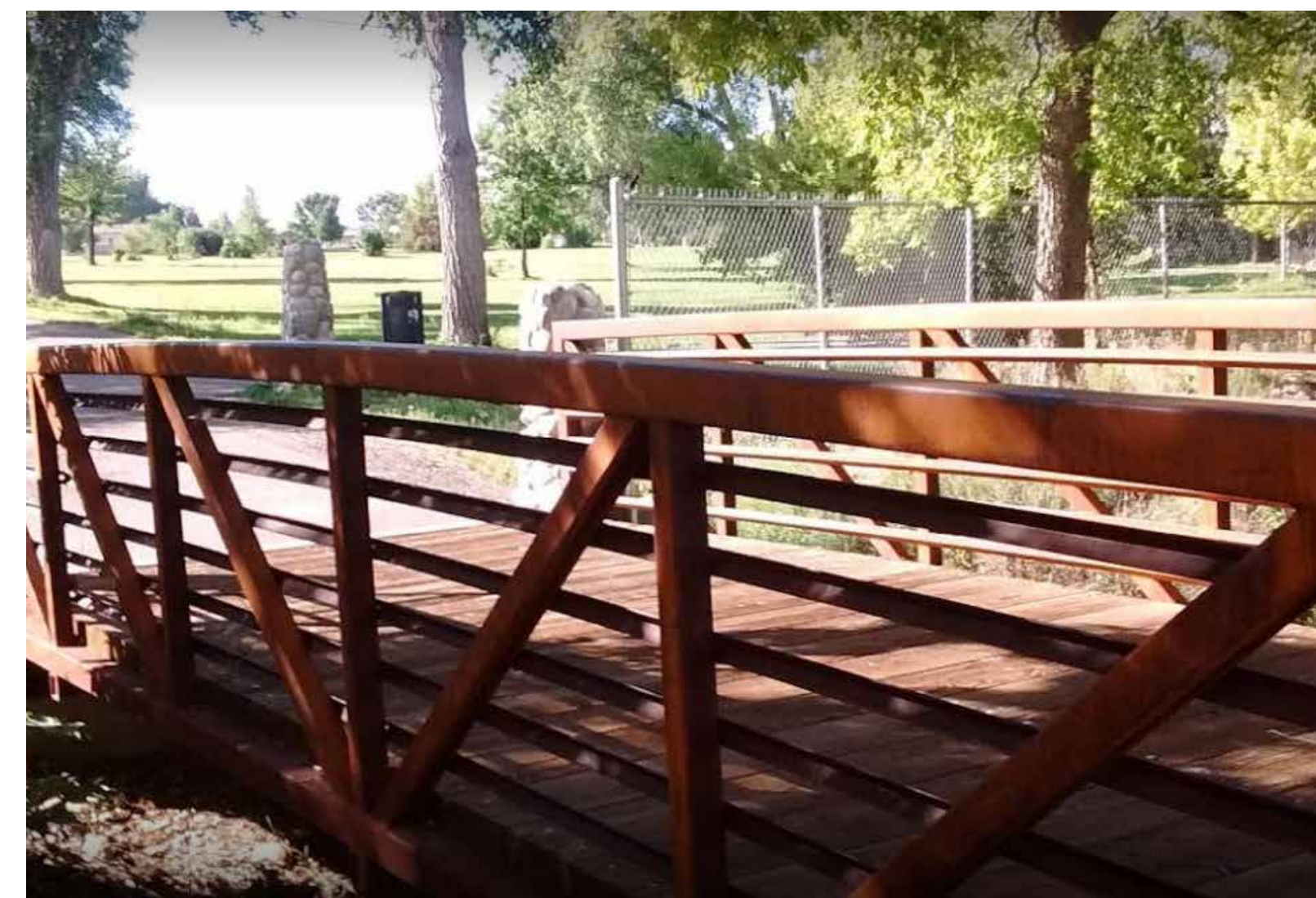

**New Bridge (Match Existing)**



**New Planting Areas**

# **Concept A Precedents: Stormwater Infrastructure & Landscape Features**



2-5 Play Equipment



5-12 Play Equipment

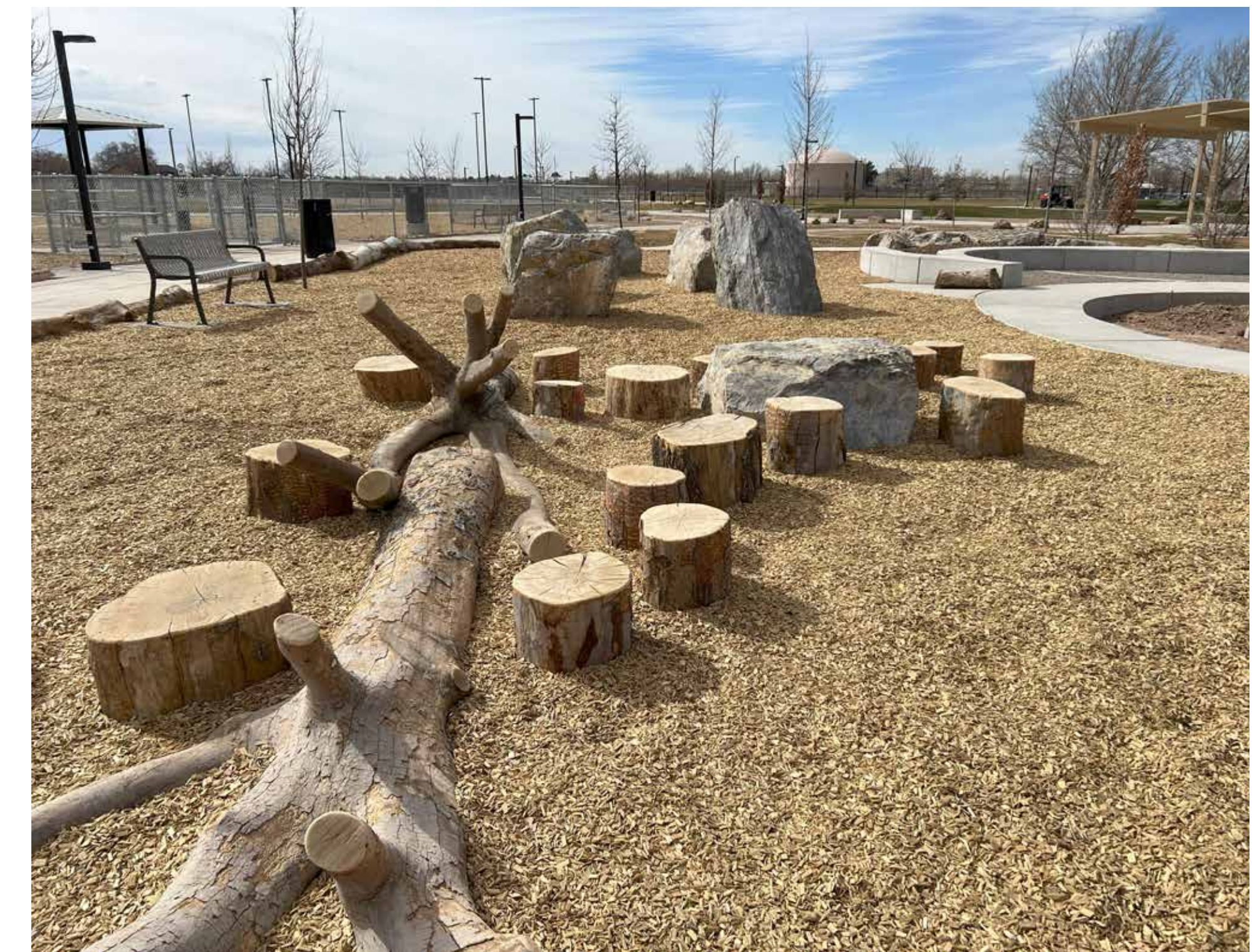

Nature Play



Disc Golf with New Course Signage



New Basketball Court



Outdoor Classroom



Water Story Interpretive Signage

# Concept A Precedents: Recreational & Educational Features



View 1



View 3



View 2

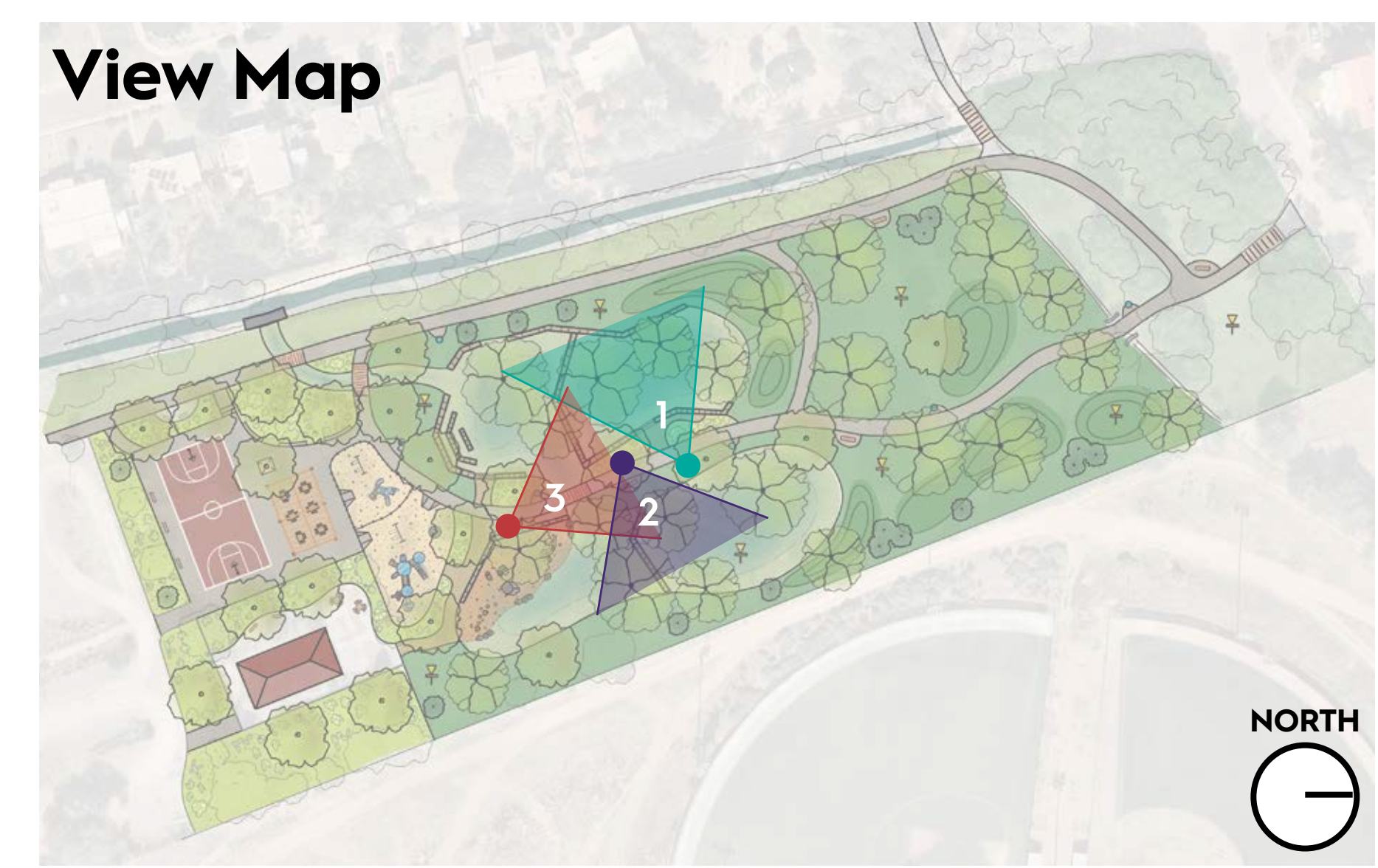

# Concept A Renderings

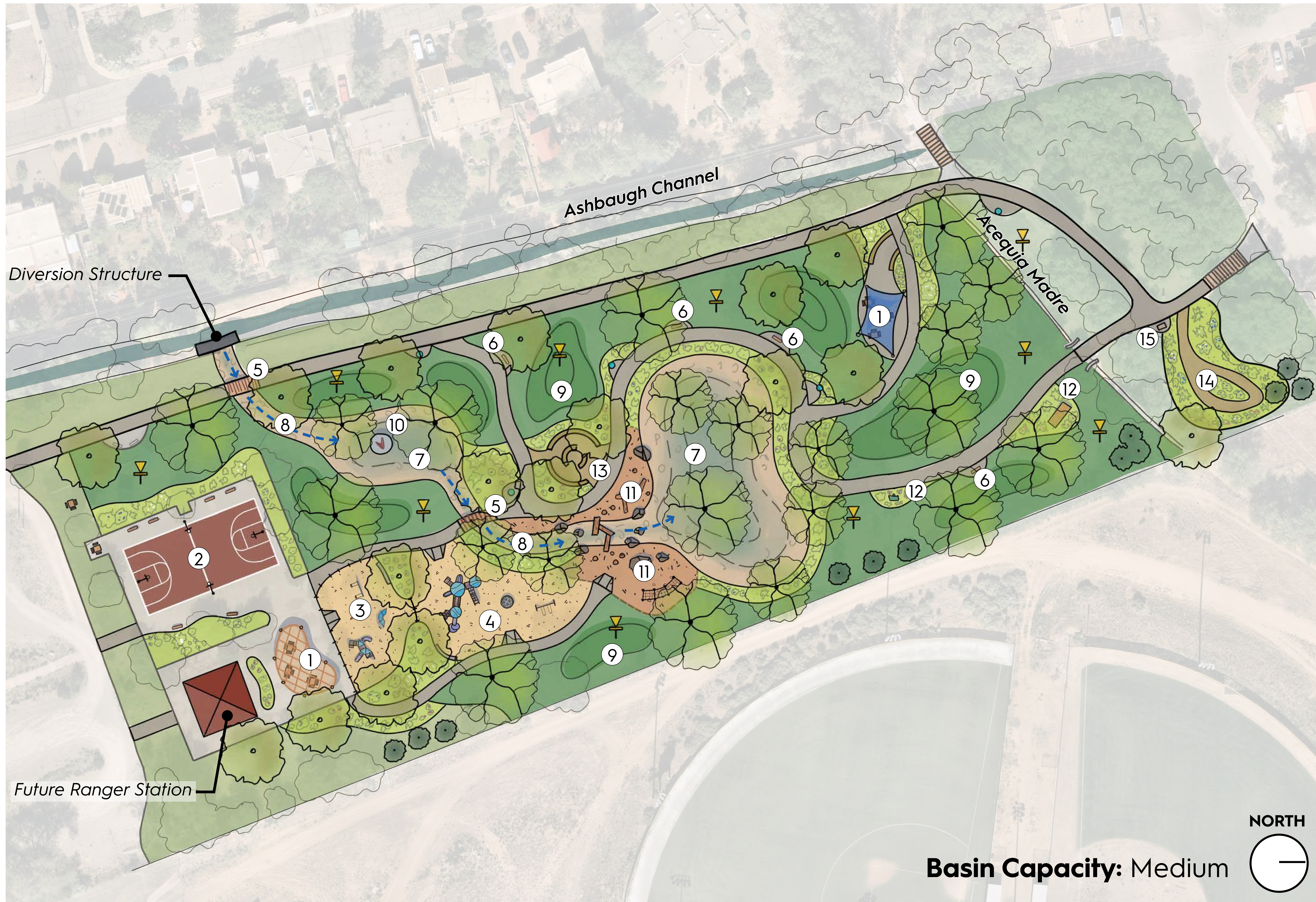

## LEGEND

- ① Shaded Gathering Area
- ② Repainted Basketball Court with Additional Hoops
- ③ Semi-Enclosed Play Area for Ages 2-5
- ④ Play Area for Ages 5-12
- ⑤ New Bridge
- ⑥ Seating Node
- ⑦ Stormwater Harvesting Basin (Cobble with Revegetation Seeding)
- ⑧ Bioswale (Cobble with Reveg. Seeding)
- ⑨ Berm
- ⑩ Art Feature in Basin
- ⑪ Nature Play Area
- ⑫ Habitat Feature
- ⑬ Outdoor Classroom
- ⑭ Native Plant / Pollinator Garden
- ⑮ Ethnobotanical Interpretive Signage
- Water Story Interpretive Signage
- ⚓ Disc Golf Tee
- > Stormwater Flow Line
- Existing Turf and Trees To Remain
- New Turf Grass
- Native Meadow Seeding
- New Planting Area
- New Concrete Paving
- New Crusher Fines Paving

# Concept B: Noticing Nature



**Diversion Structure**



**Bioswale w/ Cobble and Reveg. Seeding**



**Stormwater Harvesting Basin**



**Berm**



**Concrete Seat Walls**



**Shaded Gathering Areas**



**Seating Node**



**Paved Multi-Use Path**



**Crusher Fines Paving**

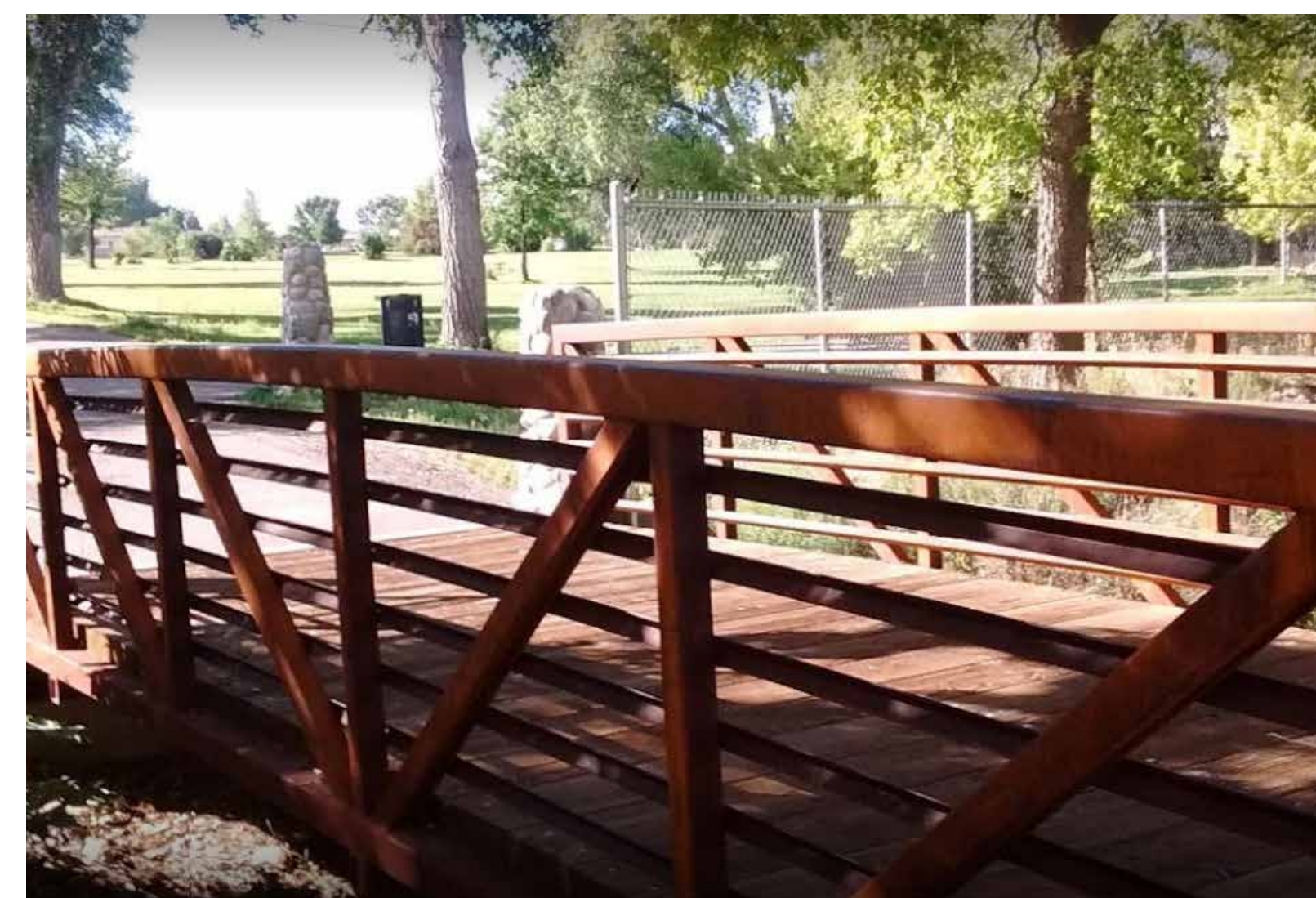

**New Bridge (Match Existing)**

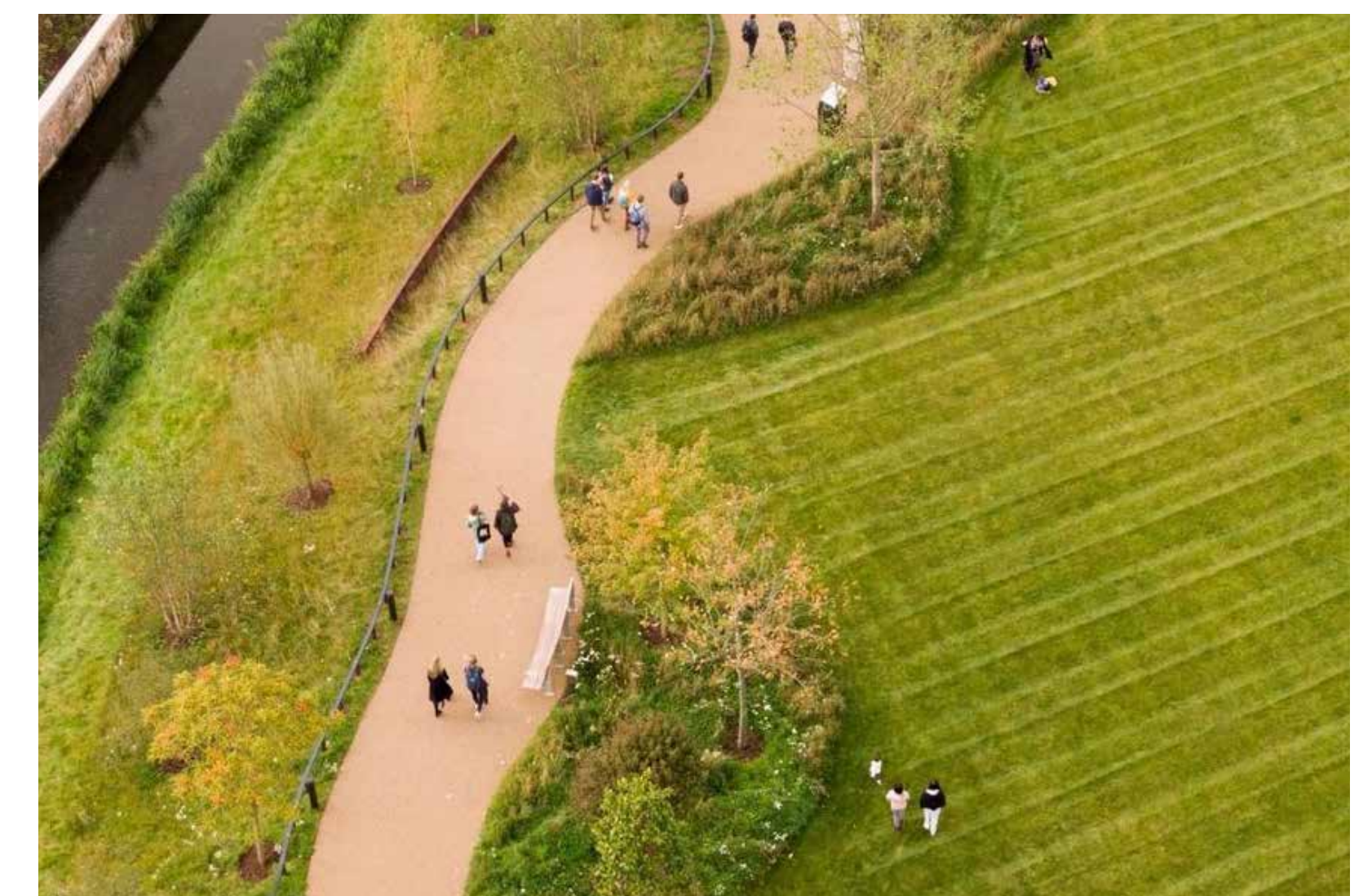

**New Planting Areas Along Path**

# **Concept B Precedents: Stormwater Infrastructure & Landscape Features**



Nature Play



2-5 Play Equipment



5-12 Play Equipment



Water Story Interpretive Signage



Native Plant / Pollinator Garden



Ethnobotanical Signage



Art Feature in Basin



Outdoor Classroom



Disc Golf with New Course Signage



Basketball Court



Habitat Feature: Bee House



Habitat Feature: Bat Box

# Concept B Precedents: Recreational & Educational Features



View 1



View 2



View 3



# Concept B Renderings

## Concept A: Sharing Stories



## Concept B: Noticing Nature



- What do you think of the two concepts?
- Which features do you like best and/or think you would use the most?
- Is there anything you would like to see in the park that you do NOT see in either of these concepts?
- How would you like to see this project recognize the Acequia Madre and history of the park?

## Discussion and Q & A

# Next Steps

- The project team will continue to gather feedback on the design concepts through email and the community input survey.

*The survey will close on May 3, 2026.*

- The design team will use this feedback to create one design concept, which they will then translate into 60% construction documents.
- **August 2026:** The 60% version of the design will be shared on the project website and via email for community input.
- This input will be considered in the construction documents as they move toward 100%.
- **December 2026:** The design team will submit 100% CDs to the City.
- **Late 2026/Early 2027:** The project team will hold a second public meeting to review the final design with the community.

# To Stay Updated on the Project and Share Your Thoughts:

Visit the Project Website  
[ashbaugh-park.squarespace.com](http://ashbaugh-park.squarespace.com)

Contact the Design Team  
[ashbaughparkrenovation@gmail.com](mailto:ashbaughparkrenovation@gmail.com)

Take the Community Input Survey  
[tinyurl.com/AshbaughReno](http://tinyurl.com/AshbaughReno)



*Thank you!*