



City of Santa Fe

Address Grid Extent



Legend

- City Address Extent
- City Limits
- Address Grid
- Roads
- Parcels

Address grid illustrated using 5000 ft cells containing 1000 potential addresses (one odd or even address every 10 feet). Address are calculated from the State Plane Coordinate System (New Mexico Central) using the following formula:
 formula:
 ((SPCY - 1705580) x 2) / 10 = North-South Address
 ((SPCX - 592670) x 2) / 10 = East-West Address
 Formula corrects for baseline at the Plaza Monument and adjusts for one odd or even address every 10 feet.

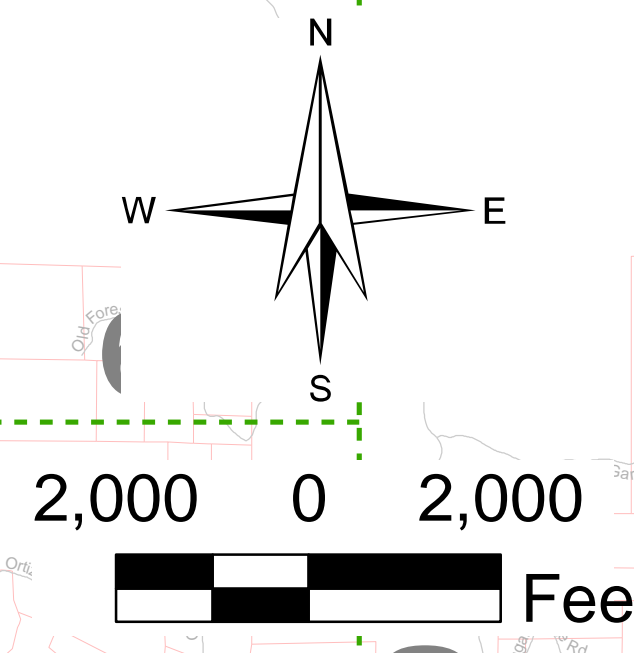
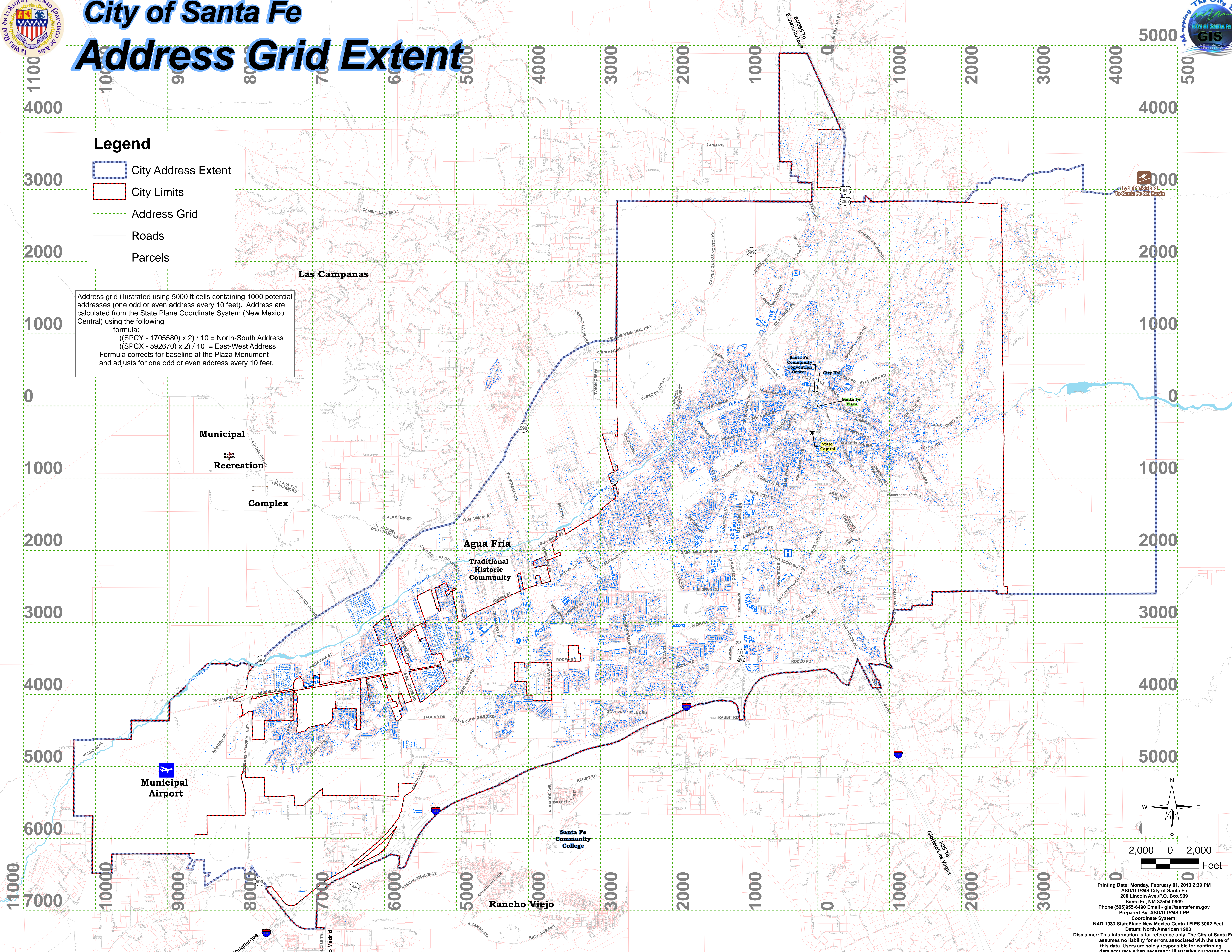

Printing Date: Monday, February 01, 2010 2:39 PM
 ASD/IT/GIS City of Santa Fe
 200 Lincoln Ave./P.O. Box 909
 Santa Fe, NM 87504-0909
 Phone (505)955-6490 Email - gis@santafemn.gov
 Prepared By: ASD/IT/GIS LPP
 Coordinate System:
 NAD 1983 StatePlane New Mexico Central FIPS 3002 Feet
 Datum: North American 1983
 Disclaimer: This information is for reference only. The City of Santa Fe assumes no liability for errors associated with the use of this data. Users are solely responsible for confirming data accuracy when necessary. Illustrative purposes only.