



4401 Masthead Street NE, Suite 150
Albuquerque, NM 87109
505-348-4000
505-348-4072 Fax

Albuquerque
Colorado Springs
Denver
Fort Worth
Houston
Kansas City
Lenexa
Los Angeles
Phoenix
Rio Rancho
Salina
San Bernardino
Wichita

Wilson & Company
Latin America, LLC

11/18/2022

TO: All Holders of Contract Documents

FOR: City of Santa Fe – Guadalupe Street Reconstruction Project

FROM: Wilson & Company Inc.

The following Addendum No.2 shall be incorporated into the Contract Documents for the above referenced project.

See attached

ALL OTHER PROVISIONS OF THE CONTRACT DOCUMENT SHALL REMAIN UNCHANGED. THIS ADDENDUM No. 1 IS HERE BY MADE A PART OF THE CONTRACT DOCUMENTS TO THE SAME EXTENT AS THOSE PROVISIONS CONTAINED IN THE ORIGINAL DOCUMENTS AND ALL ITEMS LISTING THEREOF. EACH BIDDER SHALL ACKNOWLEDGE RECEIPT OF ADDENDUM NUMBER ONE (1) ON THE BID PROPOSAL FORM IN THE SPACE PROVIDED.

Chris A. Perea, PE
Construction Operations Manager
Wilson & Company Inc

ADDENDUM No. 2
Guadalupe Street Reconstruction Project
Date of Issue: 11/18/2022

This addendum forms a part of the Contract Documents and modifies the original Bid Documents.

All other provisions of the Contract Documents shall remain unchanged. This Addendum is hereby made part of the Contract Documents to the same extent as those provisions contained in the original documents and all itemized listings thereof.

I. GENERAL:

1. The Advertisement for Bids has been updated. Bids are to be received by the City of Santa Fe Purchasing Office at purchasing_itb@santafenm.gov by 3:00 PM, December 6th, 2022. Bids will be opened via Zoom with the link below:

Join Zoom Meeting

<https://santafenm->

[gov.zoom.us/j/87988603717?pwd=L2NYTG4rTC91a0ZXTG8xQ3E0byt6Zz09](https://santafenm.gov.zoom.us/j/87988603717?pwd=L2NYTG4rTC91a0ZXTG8xQ3E0byt6Zz09)

Meeting ID: 879 8860 3717

Passcode: 638755

2. Plans and Specifications are available to be downloaded from the Wilson & Company Plan Room: <https://www.wilsonco.com/plan-room>.
3. Any reference to Reinforced Concrete Pipe (RCP) shall be Storm Drain Culvert Pipe 24" per Bid Item 570437. The concrete collar required to connect the new line to the existing storm drain is included in the cost of Bid Item 570437.
4. All surface concrete within the project shall be colored, see special provisions.
5. It is anticipated that that there will be approximately 4,000 CY of waste that is to be disposed of by the contractor.
6. Sheets 1-4, 1-7, 2-9, 2-12, 3-3, and 3-7 have been revised. See attached.
7. Bid Item List has been revised. See attached.

II. QUESTIONS AND CLARIFICATIONS:

1. The Removals of Structures and Obstructions schedule on sheet 2-10 only includes quantities for Curb & Gutter, Sidewalk, Drive pads, and Median Curb. This list does not include any items for electrical, landscaping, signage or any other items that will need to be removed as part of this project. Can a comprehensive removals schedule be provided that lists all items that need to be removed?
 - a. *A detailed list will not be provided. All removals will be per demo sheets 2-13 to 2-20, sheet 2-10 removal list, and sheets 8-1 and 9-1 for additional requirements.*
2. After reviewing the plans and contract documents, it appears that neither a detour paving section nor a detour structural number was provided. Can a detour section or structural number be provided?
 - a. *The pavement section will be 3" of HMA SP-III over existing subbase material. No R-value will be provided as existing material is to be used. Maintenance of the detour pavement will be required for this item and is included in the cost of Bid Item 405000 and NMDOT Standard Specification section 405.*
3. Bid item 31, removal of surfacing, has a quantity of 18,890 SY; however, the base course and subgrade prep items have significantly less quantity. A takeoff was also performed which also showed a lower quantity for surface removals. Can the quantity for bid item 31 be confirmed?
 - a. *We have confirmed that the quantity of Bid Item 601110 is correct.*
4. Sheet 3-3 has two call outs for installing 22"x22" CBC related to DI-05 at station 15+57.52; however, it appears that there is not a bid item for this work. All structural concrete class A is indicated for signalization, and there is not a bid item for structural concrete class AA. Can a clarification be provided that states what Bid Item is to be used for payment related to the 22"x22" CBC, and if there is not a bid item can one be established?
 - a. *The installation of a 22"x22" CBC is not required. It will be 24" storm drain culvert per Bid Item 570437. It is not known where the centerline of the existing culvert pipe is located. It will be up to the contractor and project manager to identify location for construction. The Bid Form has been revised, see revised Bid Form. The concrete collar is included in the cost of Bid Item 570437. Sheets 2-9 and 3-3 have been revised, see attached.*
5. Bid Item 122, Post Construction Plans, is commonly an allowance on all NMDOT projects. Can Bid item 122 be modified to an allowance, and if so, can the amount for this item be provided?
 - a. *Per section 802 of the NMDOT Standard Specifications, the bid item shall be lump sum.*

6. The header curb at station 25+00 shown on sheet 3-6 extends well beyond the ADA ramp. It is understood that all header curbs associated with ADA ramps are incidental to the ramps, but this section of header curb is not adjacent to an ADA ramp. The bid schedule does not have an item for header curb, so can an item be established for header curb that is not associated with ADA ramps?
 - a. *The header curb bid item will be established and paid per new Bid Item 609200. See revised Bid Form.*
7. Sheet 3-7 has a keyed note call out for 4" sidewalk for the section of sidewalk that runs through Jose St, and Sheet 3-6 does not have a call out indicating the type of sidewalk that runs through Park Ave. The Concrete Sidewalk 6" (Colored) schedule on sheet 2-10 indicates that the previously referenced sidewalk sections are 6" Colored sidewalk. Can it be confirmed that these two sections of sidewalk are to be constructed as 6" Colored Sidewalk?
 - a. *Both areas shall be 6" concrete sidewalk per Bid Item 608006.*
8. The plans do not indicate that curb and gutter nor the valley gutters with fillets are to be colored, but it appears that the curb and gutter associated with ADA Ramps and Drive Pads are to be colored. Are all sections of curb and gutter and the valley gutters to be colored, and if not, are only the sections of curb and gutter adjacent to ADA ramps and drive pads to be colored?
 - a. *Reference General Note #4 of this Addendum.*
9. What color is to be used for the colored concrete sidewalks, curb & gutter, and median paving?
 - a. *See Special Provisions sections 608 and 609.*
10. After performing quantity takeoff, it appears that the plans show a significantly lower quantity for concrete median paving than what is included on the bid schedule. Can the quantity for bid item 42 be confirmed?
 - a. *The quantity for Bid Item 608404 is correct, see Sheet 2-10 for breakdown.*
11. It appears that this project may be a net borrow project, but the bid schedule only has enough borrow to replace the unsuitable material. Will the material required to replace unsuitable be paid through Bid Item 4, Borrow?
 - a. *The borrow per Bid Item 203100 per sheet 2-1, all R-values exceed the project requirement of 20. Bid Item 203100 is established per Sheet 2-10 for the difference between the existing pavement section and proposed pavement section.*

12. Due to the project phasing and the limitation of only being able to utilize spoil material from the same phase for embankment, it appears that borrow and double handling will be required. Can the quantity for borrow be confirmed and will the contractor be paid for double handling spoils from one phase for use as embankment in a following phase?
- a. *The borrow per Bid Item 203100 per sheet 2-1, all R-values exceed the project requirement of 20.*
13. Can an earthwork report be provided?
- a. *Earthwork report is provided per Sheet 2-10 and Section 13. DTM files will be provided to the successful responsive bidder.*
14. Due to this project being broken into 17 phases and the time it will take to construct each phase, it appears that this project will take longer than 12 months/365 days to complete. Can the duration of the project be extended to 18 months/540 Days?
- a. *Project duration is 365 Days per the contract documents.*
15. What is the anticipated notice to proceed date for this project?
- a. *Spring 2023.*
16. Because detour paving is a large portion of the work that is required in the first phase, can the Notice to Proceed date be delayed until temperatures permit paving operations?
- a. *See response to question #15 above.*
17. Bid Items 34 and 35 are duplicate items. Can a clarification be provided if Bid item 35 should be for Drop Inlet Protection Type II, and if not, can a clarification be provided why there are two items for drop inlet protection type 1?
- a. *Bid Item 602251 – Drop Inlet Type II has been updated, see revised Bid Form.*
18. Scope of work notes 13 and 14 on sheet 5-3, and the Sheets 5-14 and 5-15 show water line work and sewer line work at the existing bridge, but the bid schedule does not have a bid item related to the sewer line work. The bid schedule has a bid item for 8" waterline 0-6' depth (bid item 62), and it appears that the that bid item 62 is to be used for the waterline work related to the bridge. Can it be confirmed that bid item 62 is to be used for all waterline work related to the bridge, and can a bid item be added to the bid schedule for the sewer line work?
- a. *Refer to NOTE at bottom right corner of sheet 5-14. All labor and materials to complete the utility work (water and sewer) shown on sheets 5-14 and 5-15 shall be included in the unit bid price for 8" waterline 0' to 6' depth and no separate measurement or payment will be made.*

19. Sheet 5-1 scope of work note 11 calls for the contractor to saw cut a ½” groove for a drip edge on both sides of the bridge. There is not a bid item for this work, so can a clarification be provided that states what bid item should be used for the work, or can a bid item be established?
- a. *See NOTE on right side of sheet 5-4. Sawcutting ½” drip groove shall be included in the unit bid price for repair of concrete structures.*
20. Bid Item 29, Coating of Concrete-Stain, has a bid quantity of 1833 SF. The table for this bid item on Sheet 5-1 shows a quantity of 1833 SY. Can you verify which unit of measure is correct?
- a. *The Bid Form is correct, the unit is S.F. for Coating of Concrete-Stain.*
21. The Construction Engineering and Lump Sum Item table on sheet 2-12 indicates a Utility Allowance (663000); however, the bid schedule does not contain this item. Can the Utility Allowance with its associated Dollar Value be added to the bid schedule?
- a. *On Sheet 2-12, delete Item 663000 – Utility Allowance from schedule. See revised sheet 2-12.*

III. ATTACHMENTS:

1. Updated Plan Sheets:
 - a. 1-4
 - b. 1-7
 - c. 2-9
 - d. 2-12
 - e. 3-3
 - f. 3-7
2. Updated Bid Form.

11/18/2022 M:\MSD\17-600-085-002_Disciplines_SHEETS2_Sheets - civil\SECTION 1176085_SQ01.dwg

SUMMARY OF QUANTITIES - UNIT I

NUM.	ITEM NO.	ITEM DESCRIPTION	UNIT	ROADWAY		CONSTRUCTION ENGINEERING		DETOUR		CONSTRUCTION SIGNING		PERMANENT SIGNING & STRIPING		LIGHTING		SIGNALIZATION		NON-PARTICIPATING		PROJECT TOTAL	
				ESTIMATED	FINAL	ESTIMATED	FINAL	ESTIMATED	FINAL	ESTIMATED	FINAL	ESTIMATED	FINAL	ESTIMATED	FINAL	ESTIMATED	FINAL	ESTIMATED	FINAL	ESTIMATED	FINAL
ROADWAY																					
1	107000	ENVIRONMENTAL COMMITMENTS	LS			LS															LS
2	201000	CLEARING AND GRUBBING	LS	LS																	LS
3	203000	UNCLASSIFIED EXCAVATION	CY	4020																	4020
4	203100	BORROW	CY	500																	500
5	203200	UNSUITABLE MATERIAL EXCAVATION	CY	500																	500
6	207000	SUBGRADE PREPARATION	SY	12990																	12990
7	303180	BASE COURSE 8"	SY	13470																	13470
8	405000	DETOUR PAVEMENT CONSTRUCTION	SY					1090													1090
9	407000	ASPHALT MATERIAL FOR TACK COAT	TON	5																	5
10	408100	PRIME COAT MATERIAL	TON	30																	30
11	423282	HMA SP-III COMPLETE	TON	3530																	3530
12	502030	DRILLED SHAFT FOUNDATION 30" DIAMETER	LF											60							60
13	502036	DRILLED SHAFT FOUNDATION 36" DIAMETER	LF													132					132
14	511000	STRUCTURAL CONCRETE, CLASS A	CY												12						12
15	540060	REINFORCING BARS GRADE 60	LB											3700		6680					10380
16	570437	24" STORM DRAIN CULVERT PIPE	LF	120																	120
17	601000	REMOVAL OF STRUCTURES AND OBSTRUCTIONS	LS	LS																	LS
18	601110	REMOVAL OF SURFACING (ROADWAY)	SY	18890																	18890
19	603200	SILT FENCE	LF	300																	300
20	603250	DROP INLET PROTECTION TYPE I	EA	8																	8
21	603251	DROP INLET PROTECTION TYPE II	EA	3																	3
22	603281	SWPPP PLAN PREPARATION AND MAINTENANCE	LS			LS															LS
23	608004	CONCRETE SIDEWALK 4"	SY	3690																	3690
24	608006	CONCRETE SIDEWALK 6"	SY	50																	50
25	608106	DRIVEPAD 6"	SY	1050																	1050
26	608404	CONCRETE MEDIAN PAVEMENT 4" (COLORED AND PATTERNED)	SY	188																	188
27	609200	HEADER CURB	LF	100																	100
28	609412	CONCRETE VERTICAL CURB & GUTTER TYPE B 6" x 12"	LF	3910																	3910
29	609416	CONCRETE VERTICAL CURB & GUTTER TYPE B 6" x 16"	LF	85																	85
30	609424	CONCRETE VERTICAL CURB & GUTTER TYPE B 6" X 24"	LF	4725																	4725
31	609430	CONCRETE VERTICAL CURB & GUTTER TYPE B 6" X 30"	LF	30																	30
32	609648	CONCRETE VALLEY GUTTER 6" x 48"	LF	1000																	1000
33	609708	CONCRETE LAYDOWN CURB 8"	LF	30																	30
34	617000	VIBRATION MONITORING	LS			LS															LS
35	617003	VIDEO RECORDING	LS			LS															LS
36	617004	VIBRATION RISK SURVEY	LS			LS															LS
37	618000	TRAFFIC CONTROL MANAGEMENT	LS			LS															LS
38	618011	PUBLIC AWARENESS	LS			LS															LS
39	621000	MOBILIZATION	LS	LS																	LS
40	623311	CURB DROP INLET TYPE I-B, 0' TO 4'	EA	3																	3
41	623314	CURB DROP INLET TYPE IV-B, 0' TO 4'	EA	2																	2
42	623331	CURB DROP INLET TYPE I-B, OVER 4'	EA	3																	3
43	623333	CURB DROP INLET TYPE III-B, OVER 4'	EA	1																	1
44	662400	MANHOLE ADJUSTMENT	EA	18																	18
45	663049	PRECONSTRUCTION UTILITY SURVEY	LS			LS															LS
46	663110	REMOVE & RELOCATE FIRE HYDRANT	EA	1																	1
47	663855	ADJUST VALVE BOX TO GRADE	EA	26																	26
48	663865	ADJUST WATER METER TO GRADE	EA	25																	25
49	701000	PANEL SIGNS	SF								480			16							496
50	701030	REMOVE AND RESET PANEL SIGN	EA								15										15
51	701100	STEEL POST AND BASE POST FOR ALUMINUM PANEL SIGNS	LF								910										910
52	702610	PORTABLE CHANGEABLE MESSAGE SIGN	EA							6											6
53	702810	TRAFFIC CONTROL DEVICES FOR CONSTRUCTION	LS							LS											LS
54	702811	TRAFFIC CONTROL DEVICES FOR PEDESTRIAN AND BICYCLIST	LS							LS											LS
55	704105	REMOVABLE MARKING TAPE 24"	LF							400											400

WILSON & COMPANY
 4401 MASTHEAD ST. NE SUITE 150
 ALBUQUERQUE, NM 87109
 PHONE: 505-348-4000
 FAX: 505-348-4072
 www.wilsonco.com

CONSULTANTS



PROJECT NAME
**GUADALUPE ST
 RECONSTRUCTION
 SANTA FE, NM
 CIP # 801B**

REV.	DATE	DESCRIPTION	TJA	BY
1	11/17/22	ADDENDUM #02		

WCI PROJECT NO: 1760008500
 NMDOT PROJECT NO: S100460 & LP50008
 DESIGNED BY: TJA
 DRAWN BY: JEM
 CHECKED BY: TJA
 DATE: JUL 2022

SHEET TITLE
**SUMMARY OF
 QUANTITIES - UNIT I**

SHEET NO:
1-4

11/18/2022 M:\MSD\17-600-085-002_Disciplines_SHEETS\2_Sheets - civil\SECTION 11176085_SQ01.dwg

H
G
F
E
D
C
B
A

1 2 3 4 5 6 7 8 9 10

SUMMARY OF QUANTITIES - UNIT I & II

Table with columns: NUM., ITEM NO., ITEM DESCRIPTION, PROJECT TOTAL ESTIMATED, PROJECT TOTAL FINAL. Includes items like ENVIRONMENTAL COMMITMENTS, CLEARING AND GRUBBING, UNCLASSIFIED EXCAVATION, etc.

SUMMARY OF QUANTITIES - UNIT I & II

Table with columns: NUM., ITEM NO., ITEM DESCRIPTION, PROJECT TOTAL ESTIMATED, PROJECT TOTAL FINAL. Includes items like RETROREFLECTORIZED PREFORMED PLASTIC MARKINGS (TAPE) THRU ARROW, RETROREFLECTORIZED PREFORMED PLASTIC MARKINGS (TAPE) WORD (ONLY), etc.

WILSON & COMPANY
4407 MASTHEAD ST. NE SUITE 150
ALBUQUERQUE, NM 87109
PHONE: 505-348-4000
FAX: 505-348-4072
www.wilsonco.com

CONSULTANTS



SEAL

PROJECT NAME

GUADALUPE ST
RECONSTRUCTION
SANTA FE, NM
CIP # 801B

Table with columns: REV., DATE, DESCRIPTION, TJA, BY. Includes revision 1 dated 11/17/22.

WCI PROJECT NO: 1760008500
NMDOT PROJECT NO: S100460 & LP50008
DESIGNED BY: TJA
DRAWN BY: JEM
CHECKED BY: TJA
DATE: JUL 2022

SHEET TITLE
SUMMARY OF
QUANTITIES
UNIT I & II TOTALS

SHEET NO: 1-7

1 2 3 4 5 6 7 8 9 10

11/18/2022 M:\MSD\17-600-085-002_Disciplines_SHEETS\2_Sheets - civil\SECTION 2\176085_STRO01.dwg

ESTIMATED DRAINAGE STRUCTURE QUANTITIES					570437	623311	623314	623331	623333
					24" STORM DRAIN CULVERT PIPE	CURB DROP INLET TYPE I-B 0'-4'	CURB DROP INLET TYPE IV-B 0'-4'	CURB DROP INLET TYPE I-B, OVER 4'	CURB DROP INLET TYPE III-B, OVER 4'
STATION	NAME	STRUCTURE	DEPTH (FT)	ALIGNMENT	LF	EA	EA	EA	EA
12+00	D1-01	BUILD (1) - CURB DROP INLET TYPE I-B AT 31.34' LT	5.23	GUADALUPE ST				1	
13+15	D1-02	BUILD (1) - CURB DROP INLET TYPE I-B AT 31.32' LT	5.14	GUADALUPE ST				1	
13+17	D1-03	BUILD (1) - CURB DROP INLET TYPE I-B AT 0.35' LT	4.70	GUADALUPE ST				1	
13+20	D1-04	BUILD (1) - CURB DROP INLET TYPE I-B AT 34.82' RT	3.74	GUADALUPE ST		1			
15+58	D1-05	BUILD (1) - CURB DROP INLET TYPE I-B AT 24.42' RT	3.83	GUADALUPE ST	23	1			
16+00	D1-06	BUILD (1) - CURB DROP INLET TYPE I-B AT 24.42' RT	2.63	GUADALUPE ST	4	1			
31+55	D1-07	BUILD (1) - CURB DROP INLET TYPE IV-B AT 24.42' RT	3.87	GUADALUPE ST	27		1		
32+36	D1-08	BUILD (1) - CURB DROP INLET TYPE IV-B AT 25.90' LT	3.80	GUADALUPE ST	24		1		
34+77	D1-09	BUILD (1) - CURB DROP INLET TYPE III-B AT 25.55' LT	4.50	GUADALUPE ST	20				1
PROJECT TOTAL					98	3	2	3	1
PROJECT USE					120	3	2	3	1



WILSON & COMPANY
 4401 MASTHEAD ST. NE SUITE 150
 ALBUQUERQUE, NM 87109
 PHONE: 505-348-4000
 FAX: 505-348-4072
 www.wilsonco.com

CONSULTANTS



SEAL

PROJECT NAME
**GUADALUPE ST
 RECONSTRUCTION
 SANTA FE, NM
 CIP # 801B**

REV.	DATE	DESCRIPTION	TJA	BY
1	11/17/22	ADDENDUM #02		

WCI PROJECT NO: 1760008500
 NMDOT PROJECT NO: S100460 & LP50008
 DESIGNED BY: TJA
 DRAWN BY: JEM
 CHECKED BY: TJA
 DATE: JUL 2022

SHEET TITLE
**ESTIMATED
 STRUCTURE
 QUANTITIES**

SHEET NO:
2-9

SCHEDULES AND TABLES
 SHOWN FOR CN S100460

11/17/2022 M:\MSD\17-600-085-002_Disciplines_SHEETS2_Sheets - civil\SECTION 2\1176085_MQ01.dwg

REMOVE & RELOCATE FIRE HYDRANT				ITEM NO. 663110
STATION	LOCATION	OFFSET	EACH	
16+10.69	Guadalupe St	33.25' RT	1	
PROJECT TOTAL			1	
PROJECT USE			1	

CONSTRUCTION ENGINEERING AND LUMP SUM ITEMS				
ITEM NO.	DESCRIPTION	UNIT	QUANTITY	
201000	CLEARING AND GRUBBING	LS	1	
601000	REMOVAL OF STRUCTURES AND OBSTRUCTIONS	LS	1	
603281	SWPPP PLAN PREPARATION AND MAINTENANCE	LS	1	
617000	VIBRATION MONITORING	LS	1	
617003	VIDEO RECORDING	LS	1	
617004	VIBRATION RISK SURVEY	LS	1	
618000	TRAFFIC CONTROL MANAGEMENT	LS	1	
618011	PUBLIC AWARENESS	LS	1	
621000	MOBILIZATION	LS	1	
663000	UTILITY ALLOWANCE	ALLOW	1	
663049	PRECONSTRUCTION UTILITY SURVEY	LS	1	
801000	CONSTRUCTION STAKING BY CONTRACTOR	LS	1	
802000	POST CONSTRUCTION PLANS	LS	1	

REMOVAL OF SURFACING		ITEM NO. 601110
DESCRIPTION		SY
GUADALUPE ST		
PHASE I		3045
PHASE II-A		956
PHASE II-B1		1641
PHASE II-B2		1031
PHASE II-C		2607
PHASE III-A		1056
PHASE III-B1		1366
PHASE III-B2		968
PHASE III-C		2360
PHASE V-A		43
PHASE V-B		591
PHASE V-D		51
PHASE VI-A		2236
PHASE VI-B		666
PHASE VI-C		270
PROJECT TOTAL		18886
PROJECT USE		18890

MANHOLE ADJUSTMENT				ITEM NO. 662400
STATION	LOCATION	OFFSET	EACH	
10+35.95	Guadalupe St	13.75' RT	1	
10+80.48	Guadalupe St	22.20' LT	1	
14+16.19	Alameda St	49.79' RT	1	
14+85.50	Guadalupe St	40.72' RT	1	
15+65.64	Water St	36.39' LT	1	
16+69.69	Guadalupe St	16.83' LT	1	
18+25.36	St. Francisco St	27.93' RT	1	
18+40.53	Guadalupe St	17.53' RT	1	
18+49.86	Guadalupe St	12.67' RT	1	
19+90.35	Guadalupe St	1.65' RT	1	
21+76.73	Guadalupe St	12.67' RT	1	
21+81.28	Guadalupe St	10.45' RT	1	
22+18.38	Johnson St	47.10' RT	1	
24+07.48	Guadalupe St	4.49' RT	1	
24+54.40	McKenzie St	30.62' RT	1	
25+13.81	Guadalupe St	11.32' LT	1	
28+34.21	Guadalupe St	24.05' LT	1	
39+15.00	Guadalupe St	66.37' LT	1	
PROJECT TOTAL			18	
PROJECT USE			18	

ADJUST VALVE BOX TO GRADE				ITEM NO. 663855
STATION	LOCATION	OFFSET	EACH	
10+67.76	Guadalupe St	19.00' LT	4	
14+01.59	Alameda St	34.14' LT	1	
15+68.77	Guadalupe St	22.80' RT	1	
16+46.94	Guadalupe St	18.76' RT	1	
18+11.73	San Francisco St	43.03' RT	1	
18+22.67	Guadalupe St	13.61' RT	1	
18+61.79	Guadalupe St	8.82' RT	1	
19+77.36	Guadalupe St	2.50' RT	1	
21+86.10	Johnson St	53.00' RT	2	
21+97.60	Guadalupe St	17.75' RT	1	
24+33.08	Guadalupe St	16.42' LT	1	
25+23.63	Guadalupe St	3.36' LT	1	
25+47.43	Guadalupe St	17.40' LT	1	
28+76.95	Park Ave	29.63' LT	1	
28+82.35	Park Ave	37.95' LT	1	
31+39.20	Jose St	30.81' LT	1	
32+53.00	Guadalupe St	30.48' LT	1	
33+34.23	Guadalupe St	31.73' LT	1	
33+57.79	Guadalupe St	26.05' LT	2	
39+13.59	Guadalupe St	50.00' LT	1	
39+16.96	Guadalupe St	59.56' LT	1	
PROJECT TOTAL			26	
PROJECT USE			26	

ADJUST WATER METER TO GRADE				ITEM NO. 663865
STATION	LOCATION	OFFSET	EACH	
18+35.27	San Francisco St	43.38' RT	1	
19+35.69	Guadalupe St	26.82' LT	1	
19+37.92	Guadalupe St	27.54' RT	1	
20+49.22	Guadalupe St	27.70' RT	1	
20+91.23	Guadalupe St	27.04' LT	1	
21+67.58	Guadalupe St	29.41' LT	1	
21+79.90	Guadalupe St	29.31' LT	1	
22+32.70	Guadalupe St	29.50' LT	1	
22+54.95	Guadalupe St	29.59' LT	1	
22+81.30	Guadalupe St	26.17' RT	1	
24+36.23	Guadalupe St	30.49' LT	1	
25+82.06	Guadalupe St	29.68' LT	1	
25+87.60	Guadalupe St	26.50' RT	1	
26+46.68	Guadalupe St	26.68' RT	1	
26+64.97	Guadalupe St	29.22' LT	1	
26+96.71	Guadalupe St	29.80' RT	1	
27+16.21	Guadalupe St	29.54' LT	1	
27+62.84	Guadalupe St	28.48' LT	1	
27+74.35	Guadalupe St	26.65' RT	1	
28+83.01	Park Ave	51.73' RT	1	
30+80.74	Guadalupe St	35.19' RT	1	
32+17.25	Guadalupe St	39.90' RT	1	
33+26.60	Guadalupe St	35.72' LT	1	
33+29.15	Guadalupe St	26.02' RT	1	
33+49.00	Guadalupe St	32.83' LT	1	
PROJECT TOTAL			25	
PROJECT USE			25	

WILSON & COMPANY
 4401 MASTHEAD ST. NE SUITE 150
 ALBUQUERQUE, NM 87109
 PHONE: 505-348-4000
 FAX: 505-348-4072
 www.wilsonco.com

CONSULTANTS



SEAL

GUADALUPE ST
 RECONSTRUCTION
 SANTA FE, NM
 CIP # 801B

PROJECT NAME

REV.	DATE	DESCRIPTION	TJA	BY
1	11/17/22	ADDENDUM #02		

WCI PROJECT NO: 1760008500
 NMDOT PROJECT NO: S100460 & LP50008
 DESIGNED BY: TJA
 DRAWN BY: JEM
 CHECKED BY: TJA
 DATE: JUL 2022

SHEET TITLE
 MISCELLANEOUS
 QUANTITIES

SHEET NO:
 2-12

SCHEDULES AND TABLES
 SHOWN FOR CN S100460

11/17/2022 M:\MSD\17-600-085-002_Disciplines_Sheets - civil\SECTION 31176085_PP02.dwg

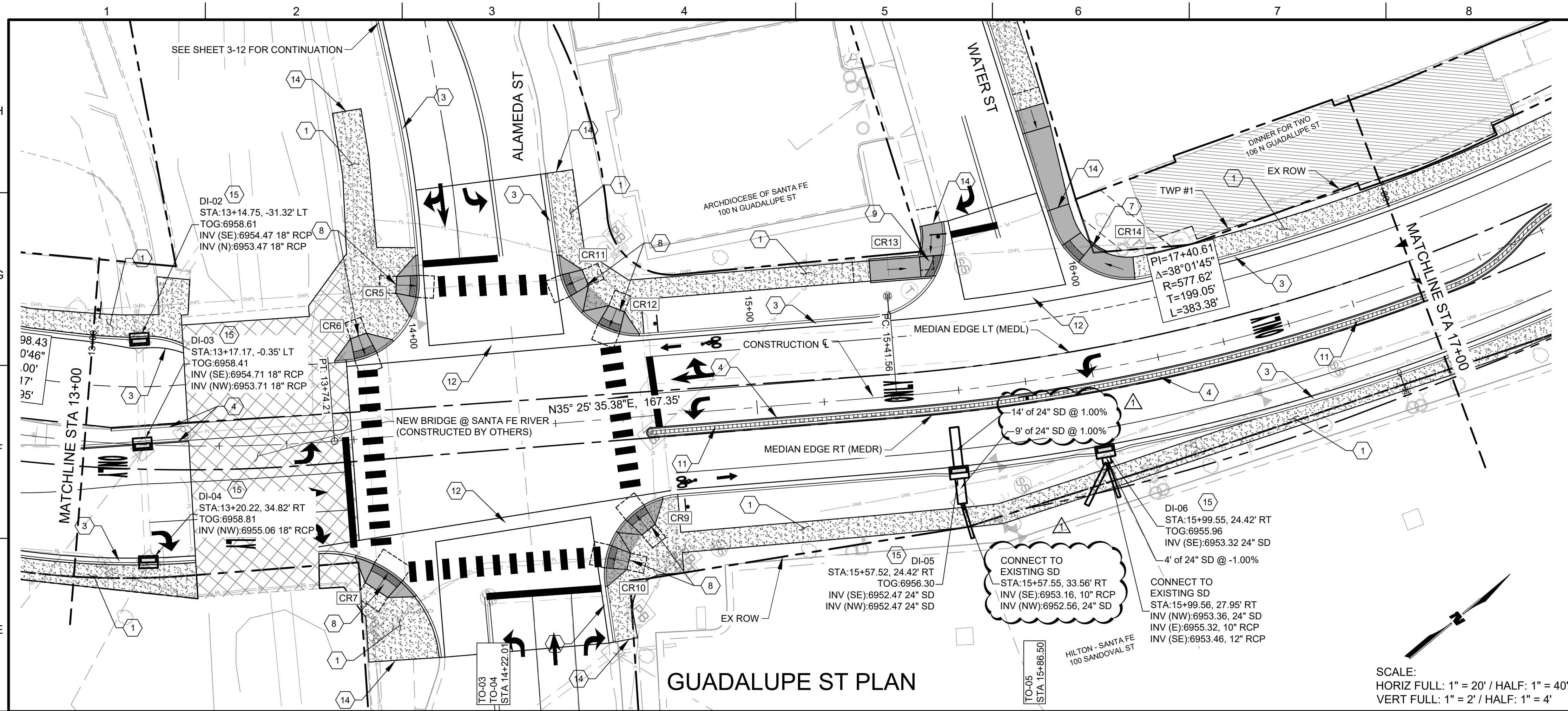

GUADALUPE ST PROFILE

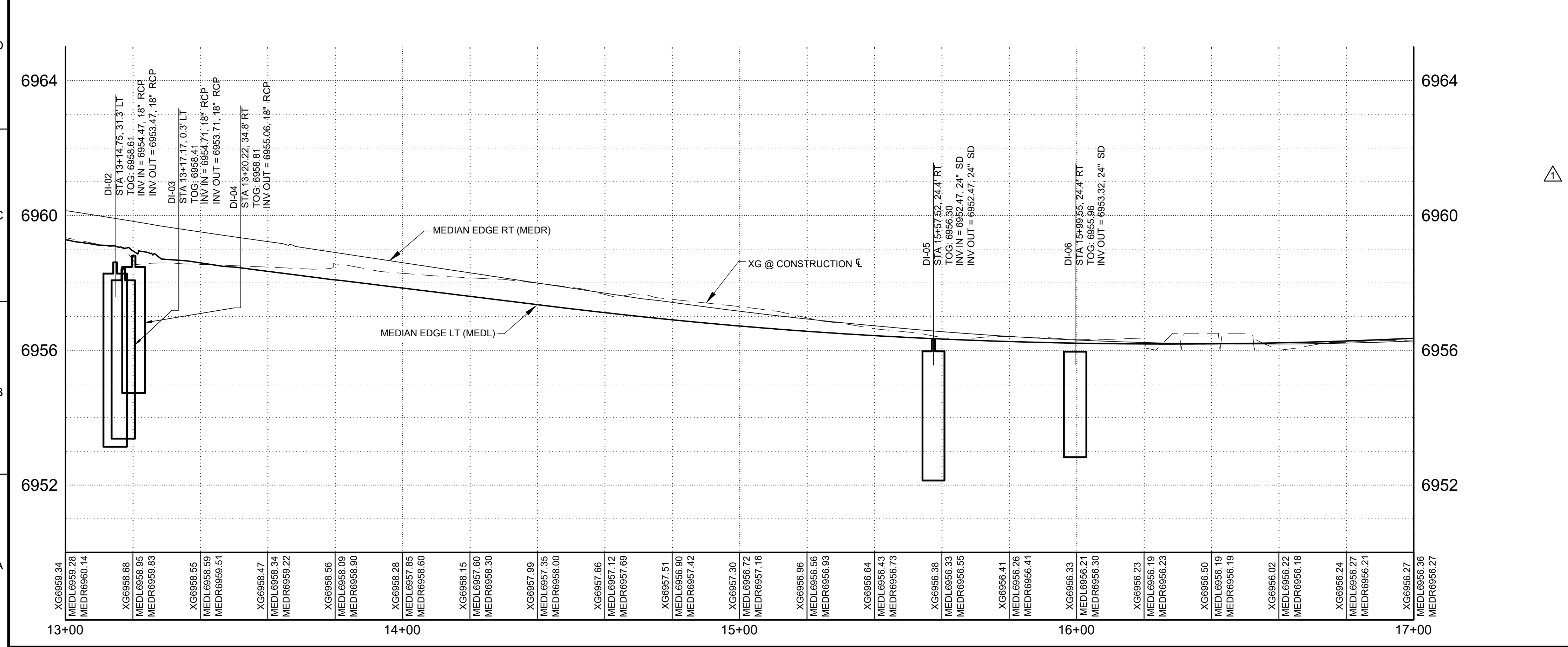

- ### GENERAL SHEET NOTES
- FOR SIDEWALK, C&G, VALLEY GUTTER AND MEDIAN PAVEMENT LAYOUT STATIONING, SEE SHEETS 3-11 THRU 3-16.
 - FOR TYPICAL SECTIONS & MISCELLANEOUS DETAILS, SEE SECTION 2 THIS SET OF PLANS.
 - FOR STORM DRAIN PLAN & PROFILES, SEE SECTION 3 THIS SET OF PLANS.
 - FOR TURNOUT / DRIVEWAY PROFILES, SEE SECTION 4 THIS SET OF PLANS.
 - FOR CONSTRUCTION SIGNING, SEE SECTION 6 THIS SET OF PLANS.
 - FOR PERMANENT SIGNING AND STRIPING, SEE SECTION 7 THIS SET OF PLANS.
 - FOR LIGHTING, SEE SECTION 8 THIS SET OF PLANS.
 - FOR SIGNALIZATION, SEE SECTION 9 THIS SET OF PLANS.
 - FOR UTILITIES, SEE SECTION 11 THIS SET OF PLANS.
 - FOR CROSS SECTIONS, SEE SECTION 13 THIS SET OF PLANS.

- ### KEYNOTES
- 4" THICK COLORED CONCRETE SIDEWALK. SEE NMDOT STD DWG 609-01.
 - CONCRETE VERTICAL CURB AND GUTTER 6"x16". SEE SHEET 2-3.
 - CONCRETE VERTICAL CURB AND GUTTER TYPE B 6"x24". SEE NMDOT STD DWG 609-01.
 - CONCRETE VERTICAL CURB AND GUTTER 6"x12". SEE SHEET 2-3.
 - DRIVE PAD 6" (COLORED). SEE SHEETS 2-33 THRU 2-36.
 - ADA PARALLEL CURB RAMP. SEE SHEETS 2-37 THRU 2-48. REFER TO NMDOT 608-001 SERIES.
 - ADA SINGLE DIAGONAL PARALLEL CURB RAMP. SEE SHEETS 2-37 THRU 2-48. REFER TO NMDOT 608-001 SERIES.
 - ADA SINGLE DIAGONAL PERPENDICULAR CURB RAMP. SEE SHEETS 2-37 THRU 2-48. REFER TO NMDOT 608-001 SERIES.
 - ADA COMBINATION CURB RAMP. SEE SHEETS 2-37 THRU 2-48. REFER TO NMDOT 608-001 SERIES.
 - ADA PERPENDICULAR CURB RAMP. SEE SHEETS 2-37 THRU 2-48. REFER TO NMDOT 608-001 SERIES.
 - CONCRETE MEDIAN PAVEMENT 4" (COLORED AND PATTERNED). SEE SHEETS 2-25 THRU 2-27.
 - CONCRETE VALLEY GUTTER 6"x48". SEE NMDOT STD DWG 609-01.
 - HEADWALL / BRIDGE BARRIER. BY OTHERS.
 - SAWCUT NEAT LINE UP TO NEAREST JOINT.
 - CURB DROP INLET TYPE I-B, 0' TO 4'. REFER TO NMDOT 623-14 SERIES.
 - CURB DROP INLET TYPE III-B, 0' TO 4'. REFER TO NMDOT 623-14 SERIES.
 - CURB DROP INLET TYPE IV-B, 0' TO 4'. REFER TO NMDOT 623-14 SERIES.
 - CUT-THROUGH MEDIAN ISLAND OPENING. SEE SHEETS 2-25 THRU 2-27. REFER TO NMDOT 608-001 SERIES.
 - PEDESTRIAN REFUGE ISLAND CURB RAMP. SEE SHEETS 2-25 THRU 2-27. REFER TO NMDOT 608-001 SERIES.
 - RAISED CURB @ SIDEWALK / CURB RAMP.
 - CONCRETE LAYDOWN CURB 8". SEE SHEET 2-6.
 - CONCRETE VERTICAL CURB & GUTTER TYPE B 6"x30". SEE NMDOT STD DWG 609-01.
 - 6" THICK COLORED CONCRETE SIDEWALK. SEE NMDOT STD DWG 609-01.

LEGEND - PLAN

- CONSTRUCTION CL
- MEDIAN EDGE LEFT
- MEDIAN EDGE RIGHT
- EXISTING ROW
- [Pattern] PROPOSED 4" COLORED CONCRETE SIDEWALK
- [Pattern] PROPOSED COLORED DRIVEWAY / ADA RAMP
- [Pattern] PROPOSED 4" CONCRETE MEDIAN PAVEMENT COLORED & PATTERNED
- [Pattern] BRIDGE @ SANTA FE RIVER (BY OTHERS)

CR: CURB RAMP
 DW: DRIVE WAY
 DI: DROP INLET
 MIR: MEDIAN ISLAND RAMP
 TO: TURNOUT
 TOG: TOP OF GRATE ELEVATION
 MEDL: MEDIAN EDGE LEFT ELEVATION
 MEDR: MEDIAN EDGE RIGHT ELEVATION
 XG: EXISTING GROUND ELEVATION

4401 MASTHEAD ST. NE SUITE 150
ALBUQUERQUE, NM 87109
PHONE: 505-348-4000
FAX: 505-348-4072
www.wilsonco.com

CONSULTANTS

TYLER J. ASHTON
NEW MEXICO
PROFESSIONAL ENGINEER
11/17/2022

PROJECT NAME

**GUADALUPE ST
RECONSTRUCTION
SANTA FE, NM
CIP # 801B**

REV.	DATE	DESCRIPTION	TJA	BY
1	11/17/22	ADDENDUM #02		

WCI PROJECT NO: 1760008500
 NMDOT PROJECT NO: S100460 & LP50008
 DESIGNED BY: TJA
 DRAWN BY: JEM
 CHECKED BY: TJA
 DATE: JUL 2022

SHEET TITLE

**ROADWAY PLAN &
PROFILE**

SHEET NO: **3-3**

11/17/2022 M:\MSD\17-600-085-002_Disciplines_Sheets - civil\SECTION 31176085_PP02.dwg

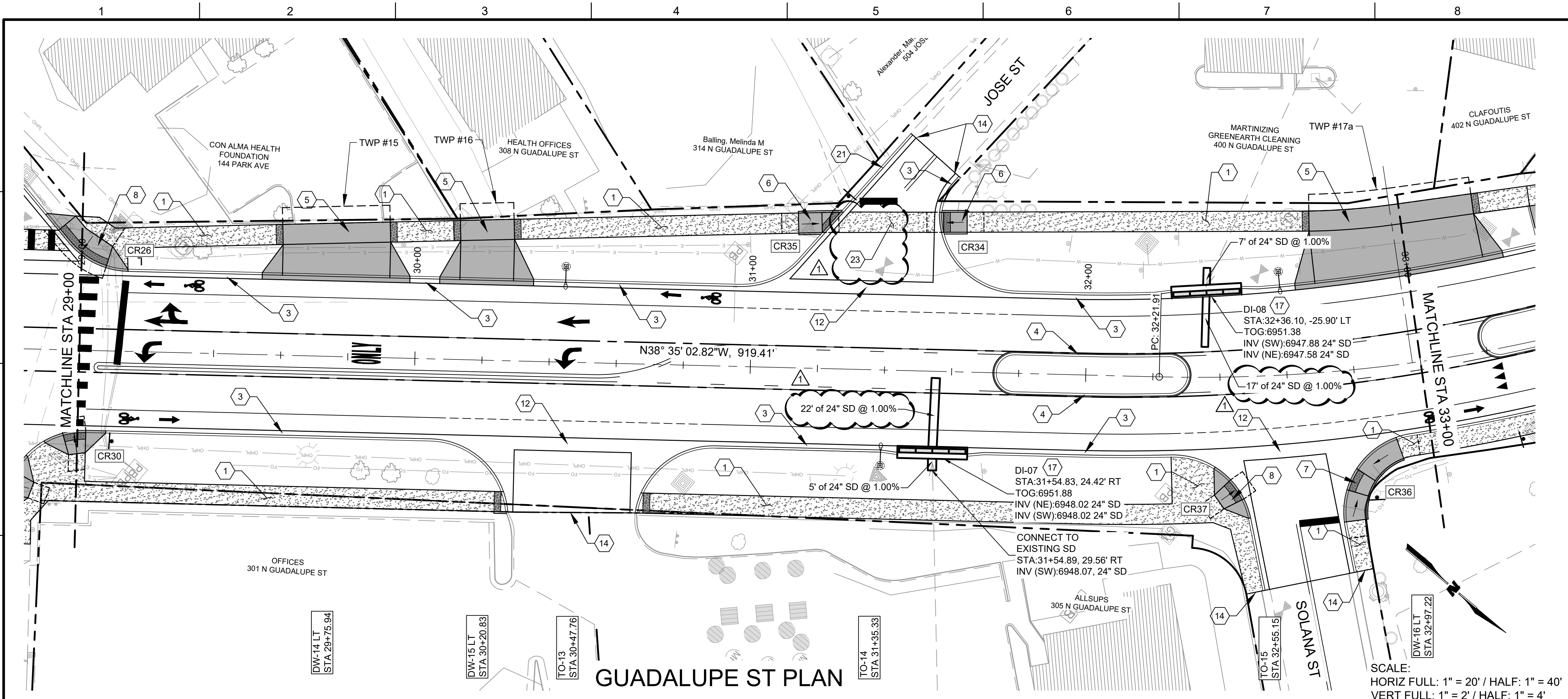

GUADALUPE ST PLAN

GUADALUPE ST PROFILE

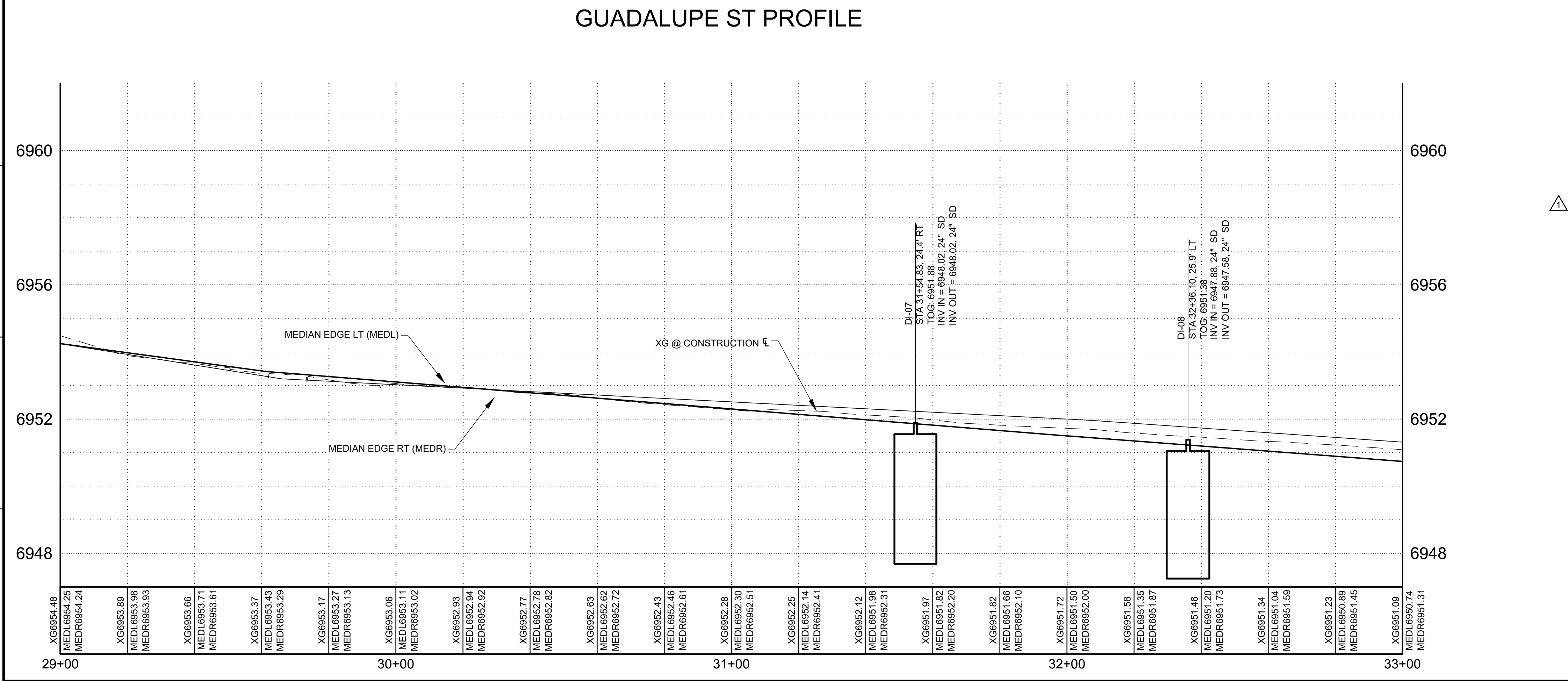

GENERAL SHEET NOTES

- FOR SIDEWALK, C&G, VALLEY GUTTER AND MEDIAN PAVEMENT LAYOUT STATIONING, SEE SHEETS 3-11 THRU 3-16.
- FOR TYPICAL SECTIONS & MISCELLANEOUS DETAILS, SEE SECTION 2 THIS SET OF PLANS.
- FOR STORM DRAIN PLAN & PROFILES, SEE SECTION 3 THIS SET OF PLANS.
- FOR TURNOUT / DRIVEWAY PROFILES, SEE SECTION 4 THIS SET OF PLANS.
- FOR CONSTRUCTION SIGNING, SEE SECTION 6 THIS SET OF PLANS.
- FOR PERMANENT SIGNING AND STRIPING, SEE SECTION 7 THIS SET OF PLANS.
- FOR LIGHTING, SEE SECTION 8 THIS SET OF PLANS.
- FOR SIGNALIZATION, SEE SECTION 9 THIS SET OF PLANS.
- FOR UTILITIES, SEE SECTION 11 THIS SET OF PLANS.
- FOR CROSS SECTIONS, SEE SECTION 13 THIS SET OF PLANS.

KEYNOTES

- 4" THICK COLORED CONCRETE SIDEWALK. SEE NMDOT STD DWG 609-01.
- CONCRETE VERTICAL CURB AND GUTTER 6"x16". SEE SHEET 2-3.
- CONCRETE VERTICAL CURB AND GUTTER TYPE B 6"x24". SEE NMDOT STD DWG 609-01.
- CONCRETE VERTICAL CURB AND GUTTER 6"x12". SEE SHEET 2-3.
- DRIVE PAD 6" (COLORED). SEE SHEETS 2-33 THRU 2-36.
- ADA PARALLEL CURB RAMP. SEE SHEETS 2-37 THRU 2-48. REFER TO NMDOT 608-001 SERIES.
- ADA SINGLE DIAGONAL PARALLEL CURB RAMP. SEE SHEETS 2-37 THRU 2-48. REFER TO NMDOT 608-001 SERIES.
- ADA SINGLE DIAGONAL PERPENDICULAR CURB RAMP. SEE SHEETS 2-37 THRU 2-48. REFER TO NMDOT 608-001 SERIES.
- ADA COMBINATION CURB RAMP. SEE SHEETS 2-37 THRU 2-48. REFER TO NMDOT 608-001 SERIES.
- ADA PERPENDICULAR CURB RAMP. SEE SHEETS 2-37 THRU 2-48. REFER TO NMDOT 608-001 SERIES.
- CONCRETE MEDIAN PAVEMENT 4" (COLORED AND PATTERNED). SEE SHEETS 2-25 THRU 2-27.
- CONCRETE VALLEY GUTTER 6"x48". SEE NMDOT STD DWG 609-01.
- HEADWALL / BRIDGE BARRIER. BY OTHERS.
- SAWCUT NEAT LINE UP TO NEAREST JOINT.
- CURB DROP INLET TYPE I-B, 0' TO 4'. REFER TO NMDOT 623-14 SERIES.
- CURB DROP INLET TYPE III-B, 0' TO 4'. REFER TO NMDOT 623-14 SERIES.
- CURB DROP INLET TYPE IV-B, 0' TO 4'. REFER TO NMDOT 623-14 SERIES.
- CUT-THROUGH MEDIAN ISLAND OPENING. SEE SHEETS 2-25 THRU 2-27. REFER TO NMDOT 608-001 SERIES.
- PEDESTRIAN REFUGE ISLAND CURB RAMP. SEE SHEETS 2-25 THRU 2-27. REFER TO NMDOT 608-001 SERIES.
- RAISED CURB @ SIDEWALK / CURB RAMP.
- CONCRETE LAYDOWN CURB 8". SEE SHEET 2-6.
- CONCRETE VERTICAL CURB & GUTTER TYPE B 6"x30". SEE NMDOT STD DWG 609-01.
- 6" THICK COLORED CONCRETE SIDEWALK. SEE NMDOT STD DWG 609-01.

LEGEND - PLAN

---	CONSTRUCTION CL
---	MEDIAN EDGE LEFT
---	MEDIAN EDGE RIGHT
---	EXISTING ROW
[Pattern]	PROPOSED 4" COLORED CONCRETE SIDEWALK
[Pattern]	PROPOSED COLORED DRIVEWAY / ADA RAMP
[Pattern]	PROPOSED 4" CONCRETE MEDIAN PAVEMENT COLORED & PATTERNED
[Pattern]	BRIDGE @ SANTA FE RIVER (BY OTHERS)
CR:	CURB RAMP
DW:	DRIVE WAY
DI:	DROP INLET
MIR:	MEDIAN ISLAND RAMP
TO:	TURNOUT
TOG:	TOP OF GRATE ELEVATION
MEDL:	MEDIAN EDGE LEFT ELEVATION
MEDR:	MEDIAN EDGE RIGHT ELEVATION
XG:	EXISTING GROUND ELEVATION

WILSON & COMPANY
 4401 MASTHEAD ST. NE SUITE 150
 ALBUQUERQUE, NM 87109
 PHONE: 505-348-4000
 FAX: 505-348-4072
 www.wilsonco.com

CONSULTANTS

TYLER J. ASHTON
 NEW MEXICO
 PROFESSIONAL ENGINEER
 11/17/2022

PROJECT NAME

**GUADALUPE ST
 RECONSTRUCTION
 SANTA FE, NM
 CIP # 801B**

REV.	DATE	DESCRIPTION	TJA	BY
1	11/17/22	ADDENDUM #02		

WCI PROJECT NO:	1760008500
NMDOT PROJECT NO:	S100460 & LP50008
DESIGNED BY:	TJA
DRAWN BY:	JEM
CHECKED BY:	TJA
DATE:	JUL 2022
SHEET TITLE	
ROADWAY PLAN & PROFILE	
SHEET NO:	

BASE BID

NUM	BID ITEM	ITEM DESCRIPTION	UNIT	ESTIMATED QUANTITY	UNIT PROJECT	UNIT PRICE	TOTAL
1	107000	ENVIRONMENTAL COMMITMENTS	L.S.	1	I		
2	201000	CLEARING AND GRUBBING	L.S.	1	I		
3	203000	UNCLASSIFIED EXCAVATION	C.Y.	4020	I		
4	203100	BORROW	C.Y.	500	I		
5	203200	UNSUITABLE MATERIAL EXCAVATION	C.Y.	500	I		
6	207000	SUBGRADE PREPARATION	S.Y.	12990	I		
7	303180	BASE COURSE 8"	S.Y.	13470	I		
8	405000	DETOUR PAVEMENT CONSTRUCTION	S.Y.	1090	I		
9	407000	ASPHALT MATERIAL FOR TACK COAT	TON	5	I		
10	408100	PRIME COAT MATERIAL	TON	30	I		
11	423282	HMA SP-III COMPLETE	TON	3530	I		
12	455000	DIAMOND GRINDING OF PCCP	S.Y.	425	II		
13	502030	DRILLED SHAFT FOUNDATION 30" DIAMETER	L.F.	60	I		
14	502036	DRILLED SHAFT FOUNDATION 36" DIAMETER	L.F.	132	I		
15	511000	STRUCTURAL CONCRETE, CLASS A	C.Y.	12	I		
16	511070	STRUCTURAL CONCRETE, CLASS HPD	C.Y.	22	II		
17	532000	PENETRATING WATER REPELLENT TREATMENT	S.Y.	82	II		
18	533000	REPAIR OF CONCRETE STRUCTURES	S.Y.	130	II		
19	533001	EMBEDDED GALVANIC ANODES	EA.	465	II		
20	533003	REPLACEMENT REINFORCING BARS	LB.	3000	II		
21	537000	POLYESTER/EPOXY CONCRETE BRIDGE DECK OVERLAY	C.Y.	31	II		

22	540060	REINFORCING BARS GRADE 60	LB.	10380	I		
23	540160	EPOXY COATED REINFORCING BARS GRADE 60	LB.	2100	II		
24	546000	RECOATING STRUCTURES	L.S.	1	II		
25	546200	SP 3 POWER TOOL CLEANING	S.F.	200	II		
26	546210	SP 11 POWER TOOL CLEANING	S.F.	100	II		
27	547000	SAFETY AND ENVIRONMENTAL REQUIREMENTS	L.S.	1	II		
28	570437	24" STORM DRAIN CULVERT PIPE	L.F.	120	I		
29	548001	COATING OF CONCRETE - STAIN	S.F.	1833	II		
30	601000	REMOVAL OF STRUCTURES AND OBSTRUCTIONS	L.S.	1	I & II		
31	601110	REMOVAL OF SURFACING (ROADWAY)	S.Y.	18890	I		
32	601110	REMOVAL OF SURFACING (BRIDGE)	S.Y.	294	II		
33	603200	SILT FENCE	L.F.	300	I		
34	603250	DROP INLET PROTECTION TYPE I	EA.	8	I		
35	603251	DROP INLET PROTECTION TYPE II	EA.	3	I		
36	603262	COMPOSTED MULCH SOCKS	L.F.	50	II		
37	603281	SWPPP PLAN PREPARATION AND MAINTENANCE	L.S.	1	I		
38	607079	PEDESTRIAN/BICYCLE RAILING	L.F.	30	II		
39	608004	CONCRETE SIDEWALK 4", INTEGRAL COLORED CONCRETE	S.Y.	3690	I		
40	608006	CONCRETE SIDEWALK 6", INTEGRAL COLORED CONCRETE	S.Y.	50	I		
41	608106	DRIVE PAD 6", INTEGRAL COLORED CONCRETE	S.Y.	1070	I		
42	608404	CONCRETE MEDIAN PAVEMENT 4" (COLORED AND PATTERNED)	S.Y.	188	I		

43	609412	CONCRETE VERTICAL CURB AND GUTTER TYPE B 6"X12"	L.F.	3910	I		
44	609416	CONCRETE VERTICAL CURB AND GUTTER TYPE B 6"X16"	L.F.	85	I		
45	609200	HEADER CURB	L.F.	100	I		
46	609424	CONCRETE VERTICAL CURB AND GUTTER TYPE B 6" X 24"	L.F.	4725	I		
47	609430	CONCRETE VERTICAL CURB AND GUTTER TYPE B 6" X 30"	L.F.	30	I		
48	609648	CONCRETE VALLEY GUTTER 6" X 48"	L.F.	1000	I		
49	609708	CONCRETE LAYDOWN CURB 8" X 24"	L.F.	30	I		
50	617000	VIBRATION MONITORING	L.S.	1	I		
51	617003	VIDEO RECORDING	L.S.	1	I		
52	617004	VIBRATION RISK SURVEY	L.S.	1	I		
53	618000	TRAFFIC CONTROL MANAGEMENT	L.S.	1	I		
54	618011	PUBLIC AWARENESS	L.S.	1	I		
55	621000	MOBILIZATION	L.S.	1	I		
56	623311	CURB DROP INLET TYPE I-B, 0' TO 4'	EA.	3	I		
57	623314	CURB DROP INLET TYPE IV-B, OVER 4'	EA.	2	I		
58	623331	CURB DROP INLET TYPE I-B, 0' TO 4'	EA.	3	I		
59	623333	CURB DROP INLET TYPE III-B, OVER 4'	EA.	1	I		
60	662400	MANHOLE ADJUSTMENT	EA.	18	I		
61	663049	PRECONSTRUCTION UTILITY SURVEY	L.S.	1	I		
62	663110	REMOVE & RELOCATE FIRE HYDRANT	EA.	1	I		
63	663728	8" WATERLINE 0' TO 6' DEPTH	L.F.	46	II		
64	663855	ADJUST VALVE BOX TO GRADE	EA.	26	I		
65	663865	ADJUST WATER METER TO GRADE	EA.	25	I		
66	701000	PANEL SIGNS	S.F.	496	I		

67	701030	REMOVE AND RESET PANEL SIGN	EACH	15	I		
68	701100	STEEL POST AND BASE POST FOR ALUMINUM PANEL SIGNS	L.F.	910	I		
69	702610	PORTABLE CHANGEABLE MESSAGE SIGN	EA.	6	I		
70	702810	TRAFFIC CONTROL DEVICES FOR CONSTRUCTION	L.S.	1	I		
71	702811	TRAFFIC CONTROL DEVICES FOR PEDESTRIAN AND BICYCLIST	L.S.	1	I		
72	704105	REMOVABLE MARKING TAPE 24"	L.F.	400	I		
73	704150	RETROREFLECTORIZED PREFORMED PLASTIC MARKING (TAPE) 4"	L.F.	16490	I		
74	704152	RETROREFLECTORIZED PREFORMED PLASTIC MARKING (TAPE) 8"	L.F.	490	I		
75	704154	RETROREFLECTORIZED PREFORMED PLASTIC MARKING (TAPE) 24"	L.F.	1710	I		
76	704156	RETROREFLECTORIZED PREFORMED PLASTIC MARKING (TAPE) COMBINATION (THRU AND RIGHT) ARROW	EA.	8	I		
77	704158	RETROREFLECTORIZED PREFORMED PLASTIC MARKING (TAPE) RIGHT ARROW	EA.	7	I		
78	704160	RETROREFLECTORIZED PREFORMED PLASTIC MARKING (TAPE) LEFT ARROW	EA.	27	I		
79	704162	RETROREFLECTORIZED PREFORMED PLASTIC MARKING (TAPE) THRU ARROW	EA.	16	I		
80	704164	RETROREFLECTORIZED PREFORMED PLASTIC MARKING (TAPE) WORD (ONLY)	EA.	15	I		

81	704166	RETROREFLECTORIZED PREFORMED PLASTIC MARKING (TAPE) YIELD LINE	L.F.	90	I		
82	704168	RETROREFLECTORIZED PREFORMED PLASTIC MARKING (TAPE) BIKE SYMBOL (BIKEWAY)	EA.	19	I		
83	706100	SERVICE RISER (SIGNAL)	EA.	2	I		
84	706110	SERVICE RISER (LIGHTING)	EA.	2	I		
85	706230	METER PEDESTAL (COMBINATION)	EA.	3	I		
86	706420	LIGHTING CONTROL CABINET-TWO CIRCUIT	EA.	2	I		
87	707004	TYPE I STANDARD, 4'	EA.	1	I		
88	707010	TYPE I STANDARD, 10'	EA.	4	I		
89	707015	TYPE I STANDARD, 15'	EA.	13	I		
90	707315	TYPE III STANDARD, 15' ARM	EA.	2	I		
91	707320	TYPE III STANDARD, 20' ARM	EA.	2	I		
92	707325	TYPE III STANDARD, 25' ARM	EA.	2	I		
93	707330	TYPE III STANDARD, 30' ARM	EA.	6	I		
94	709020	RIGID ELECTRICAL CONDUIT 2" (DIA.)	L.F.	7430	I		
95	709030	RIGID ELECTRICAL CONDUIT 3" (DIA.)	L.F.	3365	I		
96	709040	RIGID ELECTRICAL CONDUIT 4" (DIA.)	L.F.	2040	I		
97	710000	ELECTRICAL PULL BOX (STANDARD)	EA.	41	I		
98	710010	ELECTRICAL PULL BOX (LARGE)	EA.	22	I		
99	710150	ELECTRICAL PULL BOX TYPE C	EA.	10	I		
100	710400	SPLICE VAULT	EA.	3	I		
101	711005	MULTI CONDUCTOR CABLE 5	L.F.	4765	I		
102	711007	MULTI CONDUCTOR CABLE 7	L.F.	790	I		
103	711020	MULTI CONDUCTOR CABLE 20	L.F.	1515	I		
104	711108	SINGLE CONDUCTOR 8	L.F.	14130	I		

105	711110	SINGLE CONDUCTOR 10	L.F.	1535	I		
106	712011	1 SECTION TRAFFIC SIGNAL ASSEMBLY (LED)	EA.	4	I		
107	712031	3 SECTION TRAFFIC SIGNAL ASSEMBLY (LED)	EA.	27	I		
108	712051	5 SECTION TRAFFIC SIGNAL ASSEMBLY (LED)	EA.	17	I		
109	712202	PEDESTRIAN COUNTDOWN SIGNAL (LED)	EA.	20	I		
110	712330	3 SECTION BACKPLATE	EA.	12	I		
111	712350	5 SECTION BACKPLATE	EA.	8	I		
112	713025	ACCESSIBLE PEDESTRIAN SIGNAL PUSH BUTTON STATION	EA.	28	I		
113	713826	RADAR PRESENCE DETECTOR	EA.	12	I		
114	713842	RADAR DETECTOR CABLE	L.F.	1955	I		
115	713843	RADAR DETECTION CABINET INTERFACE UNIT	EA.	3	I		
116	714000	TRAFFIC ACTUATED CONTROLLER	EA.	3	I		
117	714280	8 PHASE DOUBLE RING CONTROLLER CABINET	EA.	3	I		
118	716600	ORNAMENTAL POLE & LUMINAIRE	EA.	20	I		
119	716701	LED ROADWAY LUMINAIRE	EA.	24	I		
120	721000	REMOVAL OF PAVEMENT MARKING	L.F.	260	II		
121	721101	REMOVAL OF PAVEMENT MARKING SYMBOL	EA.	3	II		
122	801000	CONSTRUCTION STAKING BY THE CONTRACTOR	L.S.	1	I		
123	802000	POST CONSTRUCTION PLANS	L.S.	1	I		

TOTAL OF BID ITEMS WITHOUT NMGR:	
---	--